



Manufactured by:  
 Backyard Discovery  
 3305 Airport Drive, Pittsburg,  
 KS 66762 800-856-4445

Basepoint Business Centre: Rivermead Drive, Westlea, Swindon SN5 7EX Phone: 0800-118-2476  
 J.P. Coenstraat 7, The Bridge, The Hague, 2595 WP, Netherlands Phone: 08005678990

# 14x10 DELRAY PERGOLA

## MODEL # : 2305014

**THE ASSEMBLY MANUAL MUST BE RETAINED SINCE IT CONTAINS IMPORTANT INFORMATION**



Please visit [www.backyarddiscovery.com](http://www.backyarddiscovery.com)  
 For the most up to date assembly manual, to register your product, or to order replacement parts *Para obtener instrucciones en español, visite*  
[www.backyarddiscovery.com](http://www.backyarddiscovery.com)



**EASY STEP-BY-STEP**  
**3D INTERACTIVE INSTRUCTIONS**  
 DOWNLOAD THE FREE APP  
 



**INSTALLATION SERVICES AVAILABLE!**  
 See inside for details

# OWNER'S MANUAL - BASIC SETUP DIMENSIONS & ASSEMBLY NOTES

It is critically important that you start with square and level footings, concrete pad or deck to attach your structure

- Pay close attention to the items needed for each step. Make sure you are using the correct hardware for each step. Using incorrect hardware may result in improper assembly
- Remember to double check for underground utilities and overhead electrical lines

**Post mounts are provided with your structure which allows you to permanently install your structure to a pre-existing or new wood or concrete surface. See Anchor Instructions for further details and recommendations.**

- The hardware to attach the post mounts to the structure is included.
- The hardware to mount the structure permanently to a concrete surface is included.
- The hardware to mount the structure permanently to a wood deck is NOT included and will need to be purchased separately. You must ensure there is ample structural support under the deck before permanently attaching.

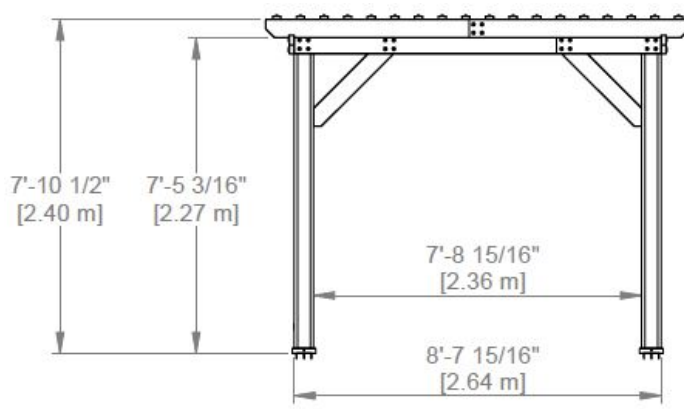
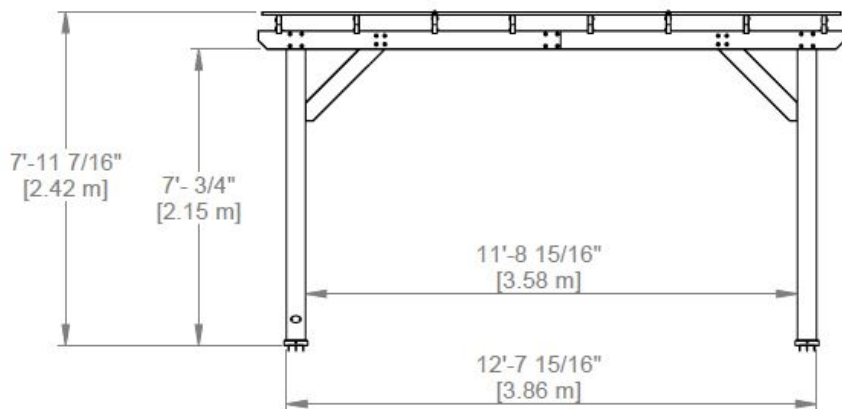
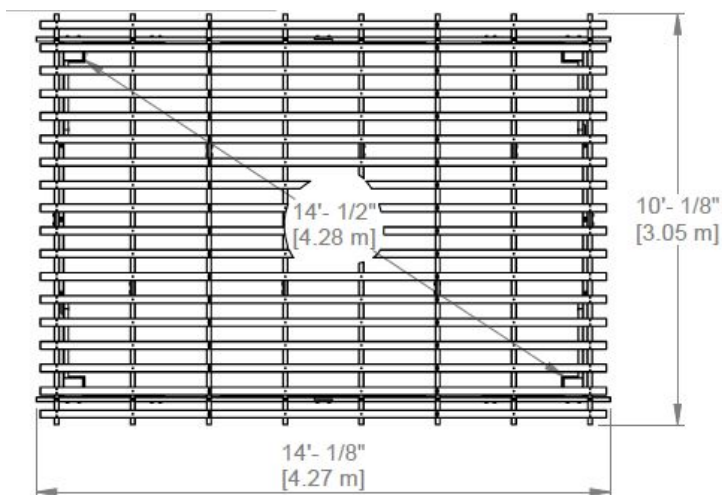

# OWNER'S MANUAL - ANCHORING LAYOUT

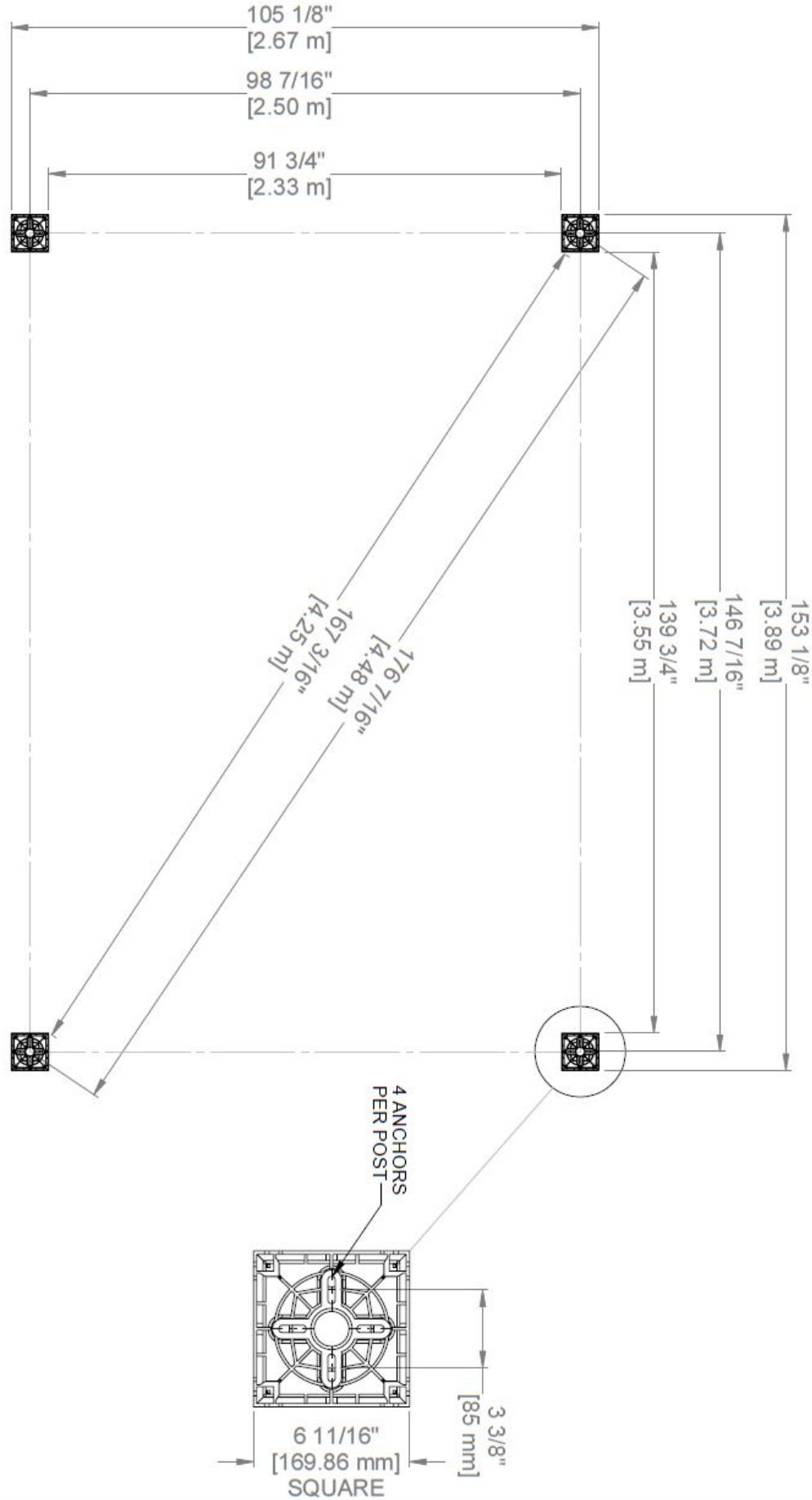

# OWNER'S MANUAL - PARTS IDENTIFICATION

## Wood Components (Not to Scale)



**D01 | BEAM-W4L16757**  
(x4) | 1 7/16"x5 1/4"x86 11/16" (36x134x2202)



**D02 | SIDE BEAM-W4L16758**  
(x2) | 1 7/16"x5 1/4"x79 9/16" (36x134x2021)



**D03 | SIDE SHORT BEAM-W4L16759**  
(x2) | 1 7/16"x5 1/4"x29 5/8" (36x134x753)

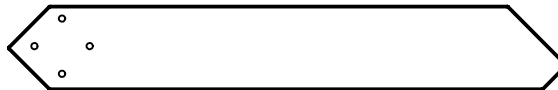

**D04 | CORBEL-W4L16760**  
(x7) | 1 7/16"x5 1/4"x35 1/16" (36x134x890)



**D05 | OUTER JOIST-W4L16761**  
(x4) | 1 7/16"x5 1/4"x62 3/8" (36x134x1585)



**D06 | INNER JOIST LONG-W4L16762**  
(x6) | 1 7/16"x5 1/4"x89 1/2" (36x134x2274)



**D07 | INNER JOIST SHORT-W4L16763**  
(x6) | 1 7/16"x5 1/4"x35 1/4" (36x134x896)

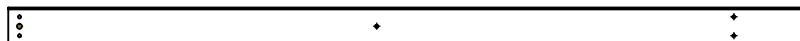

**J01 | END SLAT-W4L16764**  
(x36) | 15/16"x2 3/8"x50 3/16" (24x60x1274)



**J02 | MIDDLE SLAT-W4L16765**  
(x18) | 15/16"x2 3/8"x68 3/8" (24x60x1736)



**G01 | BEAM SUPPORT-W4L16766**  
(x2) | 15/16"x5 1/4"x60" (24x134x1524)



# OWNER'S MANUAL - PARTS IDENTIFICATION

## Wood Components (Not to Scale)

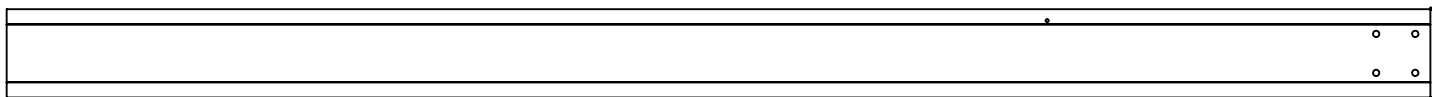

**P1 | POST-W2A03472**  
(x2) | 5 1/2"x5 1/2"x89 1/2" (140x140x2274)

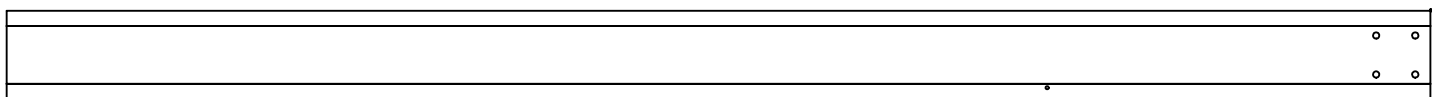

**P2 | POST-W2A03473**  
(x2) | 5 1/2"x5 1/2"x89 1/2" (140x140x2274)

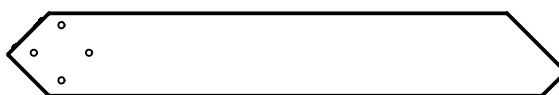

**D08 | CORBEL W/ ID TAG-W2A03481**  
(x1) | 1 7/16"x5 1/4"x35 1/16" (36x134x890)

## Accessory Components (Not to Scale)

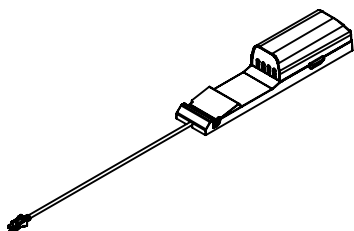

**9205413 | ELECTRICAL ENCLOSURE**  
(x1)

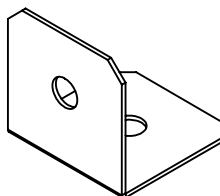

**A4M01785 | ANGLE BRACKET**  
(x6)

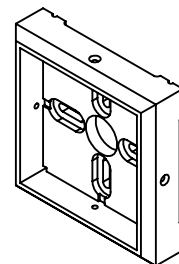

**A100029 | FOOT 142 SQUARE POST**  
(x4)



**A100241 | BYD ID TAG (SMALL) WITHOUT AGES**  
(x1)

# OWNER'S MANUAL - PARTS IDENTIFICATION

## Hardware Components (Not to Scale)

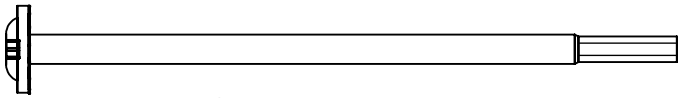

**H101037 | BOLT WH BLK**  
(x34) | 5/16 x 6 3/4

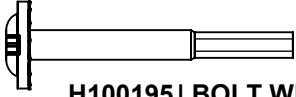

**H100195 | BOLT WH BLK**  
(x34) | 5/16 x 2 3/4

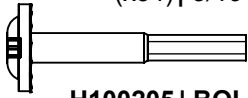

**H100205 | BOLT WH BLK**  
(x9) | 5/16 x 2 1/4

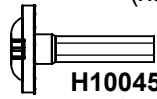

**H100459 | BOLT WH BLK**  
(x34) | 5/16 x 1 1/4

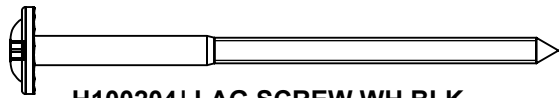

**H100204 | LAG SCREW WH BLK**  
(x18) | 5/16 x 5 1/2

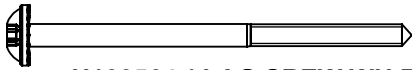

**H100564 | LAG SREW WH BLK**  
(x9) | 1/4 x 4

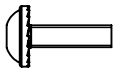

**H101139 | BOLT WH BLK**  
(x38) | 1/4 x 7/8



**H100398 | T-NUT BLK**  
(x38) | 1/4



**H100379 | T-NUT BLK**  
(x106) | 5/16

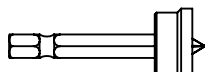

**H100764 | SCREW SETTER**  
(x1)

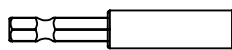

**H101100 | MAGNETIC DRIVER**  
(x1)

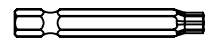

**H100147 | T-30 TORX BIT**  
(x1)



**H100114 | TORX WRENCH**  
(x1) | T-30

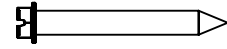

**H100120 | SCREW CONCRETE ANCHOR**  
(x18)



**H100391 | SCREW PFH BLK**  
(x220) | 8 x 2



**H100382 | SCREW PFH BLK**  
(x26) | 8 x 1 3/4



**H100200 | SCREW PFH BLK**  
(x17) | 8 x 1 1/2



**H100797 | SCREW PWH BLK**  
(x13) | 8 x 1



**H100392 | SCREW PWH BLK**  
(x2) | 8 x 3/4



**H100630 | WASHER FLAT BLK**  
(x17) | 8 x 19



**H100405 | WASHER LOCK EXT BLK**  
(x46) | 6 x 15



**H100198 | WASHER LOCK EXT BLK**  
(x124) | 12 x 18

# PRE-ASSEMBLY STEP 1 - TOOLS REQUIRED



Cordless Drill  
or Electric Drill



Drill  
Attachments:  
Phillips Head



1/8", 3/16", 3/8" &  
7/16" Drill Bits

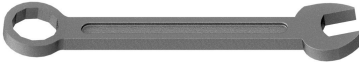

Open End  
Wrenches  
1/2" & 7/16"



3/8" Drive Ratchet, 1/2" &  
7/16" STD Sockets, 1/2" &  
7/16" Deep Sockets



Tape Measure



Claw Hammer



Phillips Screw Driver

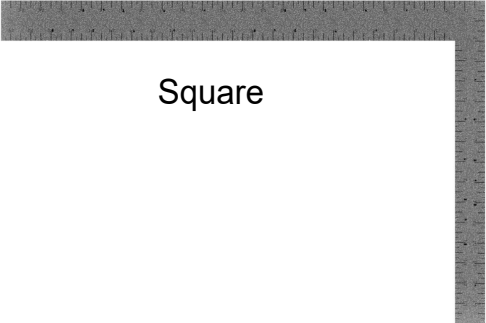

Square



Level 24"

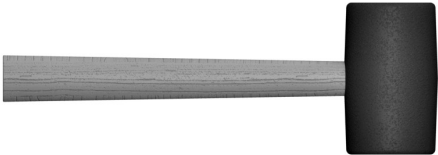

Rubber Mallet  
- Optional

## PRE-ASSEMBLY STEP 2 - SORTING PARTS

It is critical for ease of assembly that you take the time to sort and organize the wood and hardware.

---

### WOOD PARTS:

- Organize wood parts by the three-digit, alpha-numeric number stamped on each board (ex. P01).
- If there are multiple boards with the same stamped number, stack those pieces together.
- Stamps can be found on the flat surface of the boards or on the end of the boards.
- Allow yourself plenty of room - the wood pieces can take up a significant amount of space.

**NOTE: CARTONS ARE NOT ORGANIZED BY BOARD NUMBER.**



### HARDWARE PARTS:

- We recommend that you have a separate table to organize the hardware.
- Hardware bags are printed with a seven-digit, alpha-numeric part number.
- You can organize your hardware by part number or group by hardware type (i.e. bolts, nuts, etc.).
- During assembly you only need to reference the last four digits of the number.

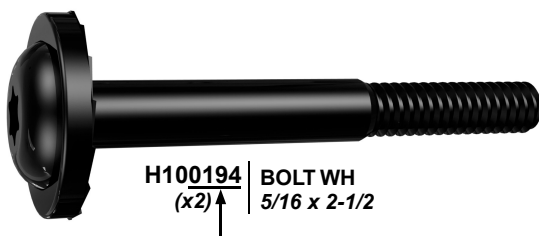

# PRE-ASSEMBLY STEP 3 - CHOOSE YOUR ASSEMBLY METHOD

There are several types of assembly instructions available to you.

1. Printed Assembly Manual included with your set
2. BILT APP - 3D interactive instructions
3. Combination of the Printed Manual and BILT APP (Note: Step numbers can differ between the two methods)



The graphic is a rectangular advertisement for the BILT app. At the top left is the BILT logo, which consists of a hexagonal icon with a white dot inside, followed by the word "BILT." in a bold, sans-serif font with a registered trademark symbol. To the right of the logo is a large QR code. Below the logo and QR code, the text "Scan for easy 3D instructions" is written in a large, bold, black font. Underneath this, in a smaller font, it says "Download the BILT app before you begin". To the right of this text are two buttons: "Download on the App Store" with the Apple logo and "GET IT ON Google Play" with the Google Play logo. At the bottom of the graphic is a smartphone displaying the BILT app interface. The screen shows a 3D model of a metal frame with a horizontal bar and several hanging components. The app interface includes a "Hardware Needed" button at the top left, a close button (X) at the top right, a menu button (three dots) below the close button, a back button (left arrow) at the bottom left, a play/pause button (two vertical bars) at the bottom center, and a forward button (right arrow) at the bottom right. A small circle with the number "17" is visible in the bottom left corner of the phone screen.

# STEP 1 - PERGOLA ASSEMBLY

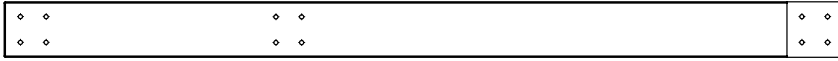

**D02 | SIDE BEAM-W4L16758**  
(x2) | 1 7/16"x5 1/4"x79 9/16" (36x134x2021)



**D03 | SIDE SHORT BEAM-W4L16759**  
(x2) | 1 7/16"x5 1/4"x29 5/8" (36x134x753)



**D04 | CORBEL-W4L16760**  
(x4) | 1 7/16"x5 1/4"x35 1/16" (36x134x890)

| Qty | PART NUMBER | DESCRIPTION            |
|-----|-------------|------------------------|
| 16  | H100198     | WASHER LOCK EXT 8x19   |
| 16  | H100379     | T-NUT 5/16 BLK         |
| 16  | H100195     | BOLT WH 5/16x2 3/4 BLK |

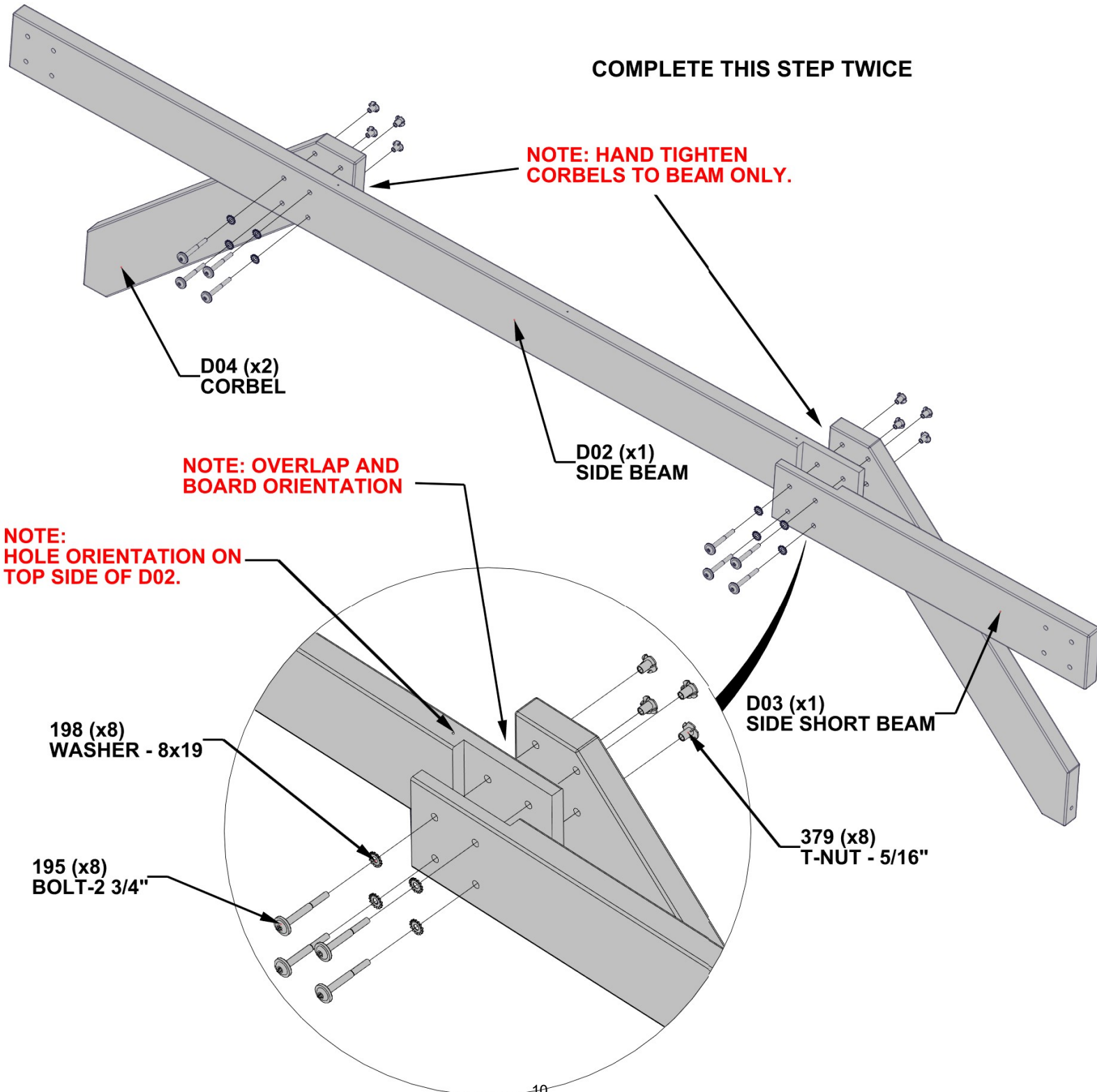

# STEP 2 - PERGOLA ASSEMBLY

| Qty | PART NUMBER | DESCRIPTION            |
|-----|-------------|------------------------|
| 2   | H100405     | WASHER LOCK EXT 6x15   |
| 2   | H100564     | LAG SCREW WH 1/4x4 BLK |
| 8   | H100198     | WASHER LOCK EXT 8x19   |
| 8   | H100379     | T-NUT 5/16 BLK         |
| 8   | H101037     | BOLT WH 5/16x6 3/4 BLK |

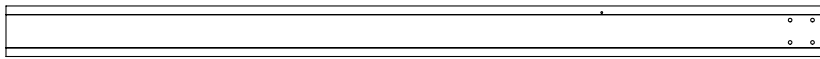

**P1 | POST-W2A03472**  
(x1) | 5 1/2"x5 1/2"x89 1/2" (140x140x2274)

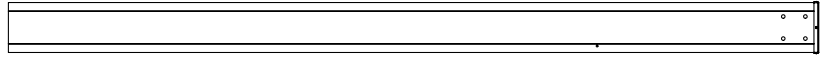

**P2 | POST-W2A03473**  
(x1) | 5 1/2"x5 1/2"x89 1/2" (140x140x2274)



**BEAM ASSEMBLY FROM STEP 1**

**NOTE: ALIGN BEAM ASSEMBLY FROM STEP 1 WITH HOLES IN POST. SQUARE BEAM ASSEMBLY TO EACH POST. TIGHTEN ALL FASTENERS FROM PREVIOUS STEP.**

**TIP: IF BOLT DOES NOT ENGAGE WITH T-NUT, CHECK FOR SAWDUST BUILD UP IN HOLES.**

**NOTE: HOLE ORIENTATION ON EACH POST**

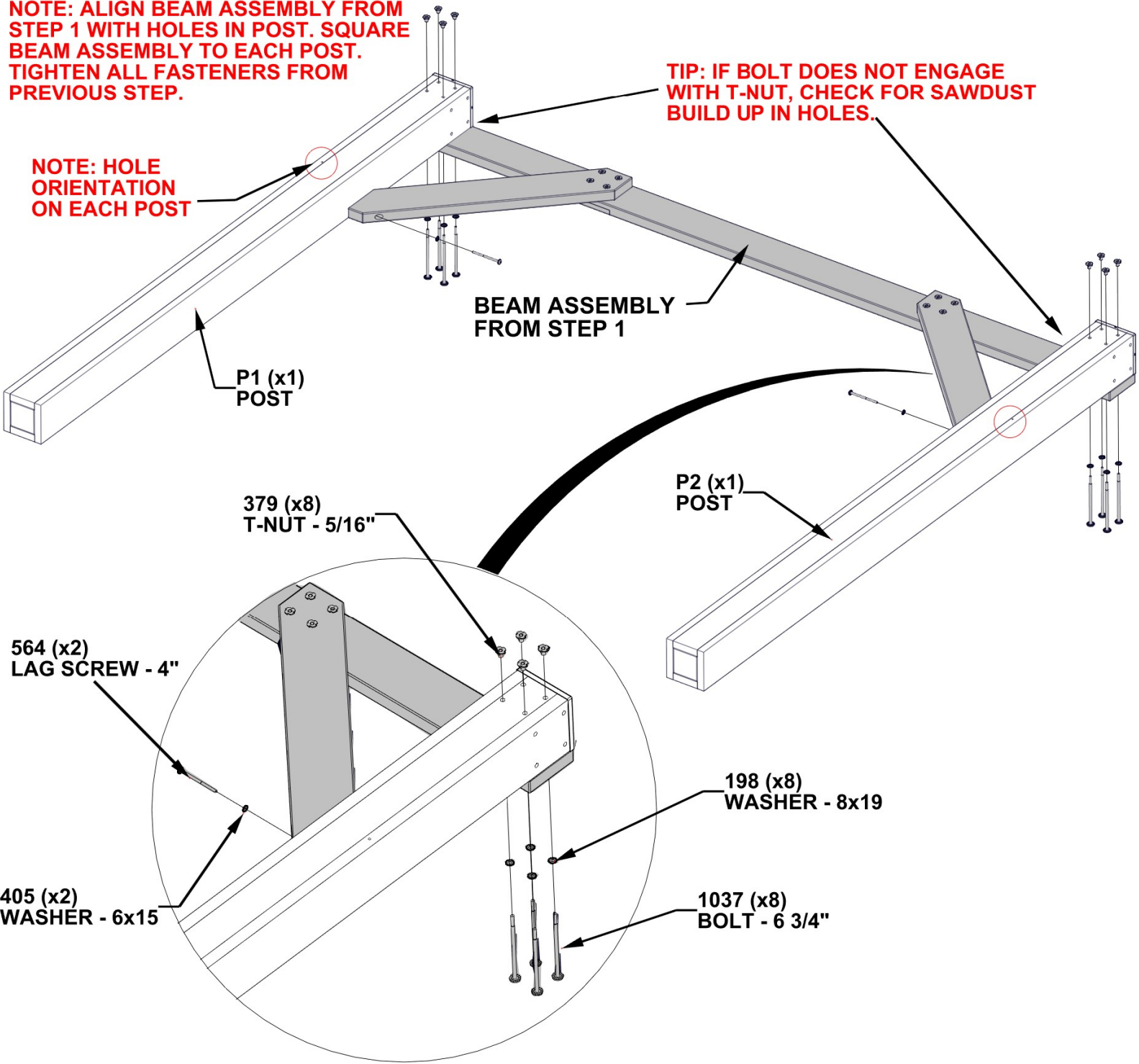



# STEP 3 - PERGOLA ASSEMBLY

| Qty | PART NUMBER | DESCRIPTION            |
|-----|-------------|------------------------|
| 2   | H100564     | LAG SCREW WH 1/4x4 BLK |
| 2   | H100405     | WASHER LOCK EXT 6x15   |
| 8   | H100379     | T-NUT 5/16 BLK         |
| 8   | H100198     | WASHER LOCK EXT 8x19   |
| 8   | H101037     | BOLT WH 5/16x6 3/4 BLK |

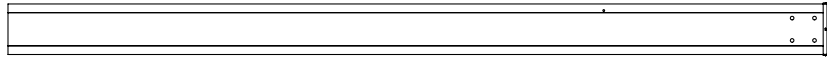

**P1 | POST-W2A03472**  
(x1) | 5 1/2"x5 1/2"x89 1/2" (140x140x2274)

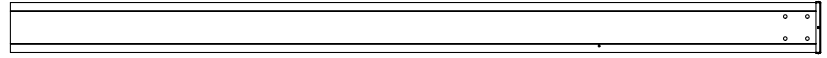

**P2 | POST-W2A03473**  
(x1) | 5 1/2"x5 1/2"x89 1/2" (140x140x2274)



**BEAM ASSEMBLY FROM STEP 1**

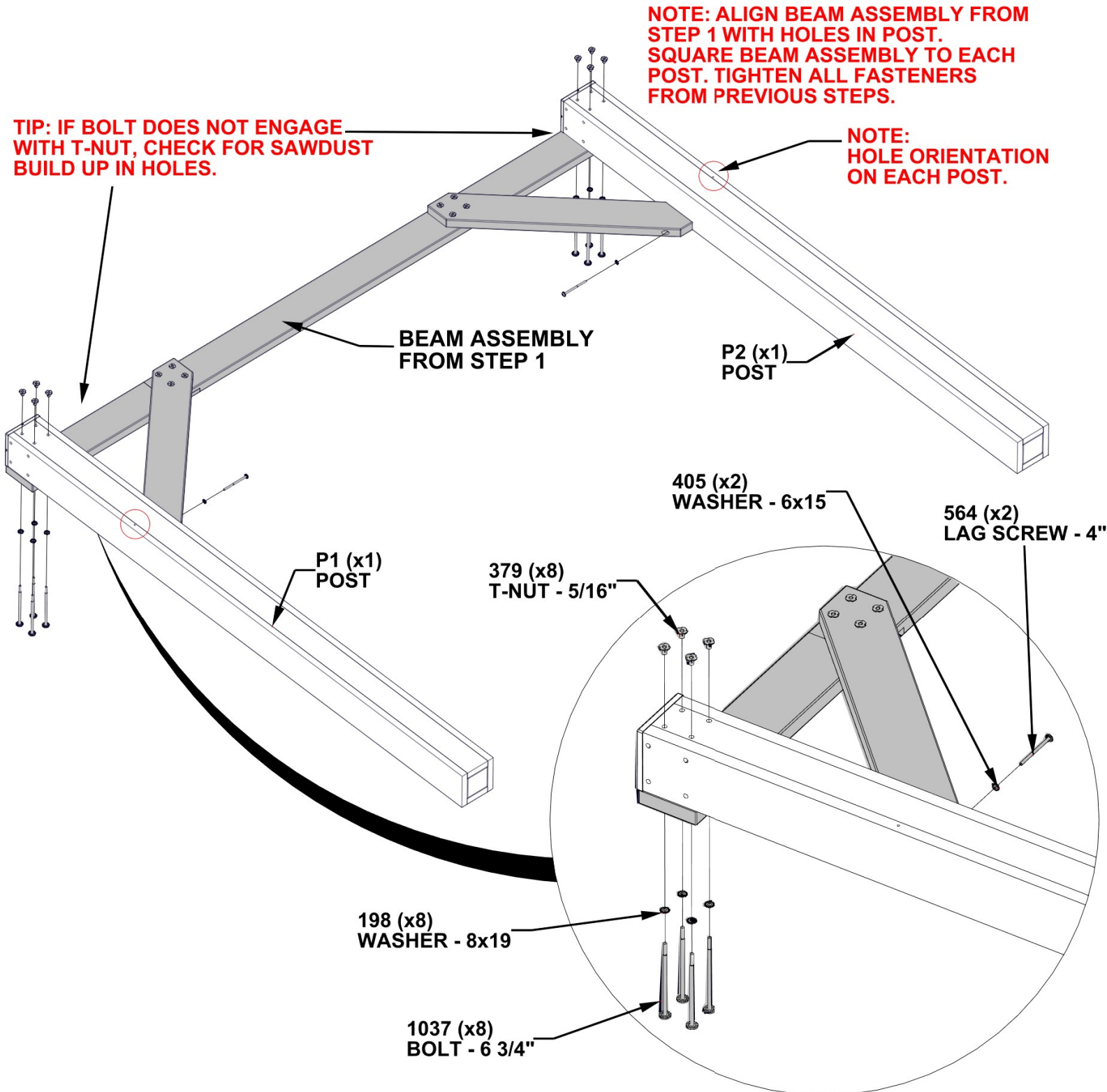



# STEP 4 - PERGOLA ASSEMBLY



**D01 | BEAM-W4L16757**  
(x4) | 1 7/16"x5 1/4"x86 11/16" (36x134x2202)

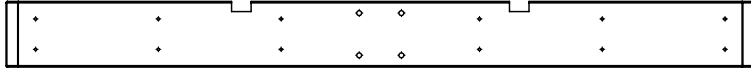

**G01 | BEAM SUPPORT-W4L16766**  
(x2) | 15/16"x5 1/4"x60" (24x134x1524)

| Qty | PART NUMBER | DESCRIPTION            |
|-----|-------------|------------------------|
| 8   | H100379     | T-NUT 5/16 BLK         |
| 8   | H100198     | WASHER LOCK EXT 8x19   |
| 8   | H100205     | BOLT WH 5/16x2 1/4 BLK |
| 24  | H100382     | SCREW PFH 8x1 3/4 BLK  |

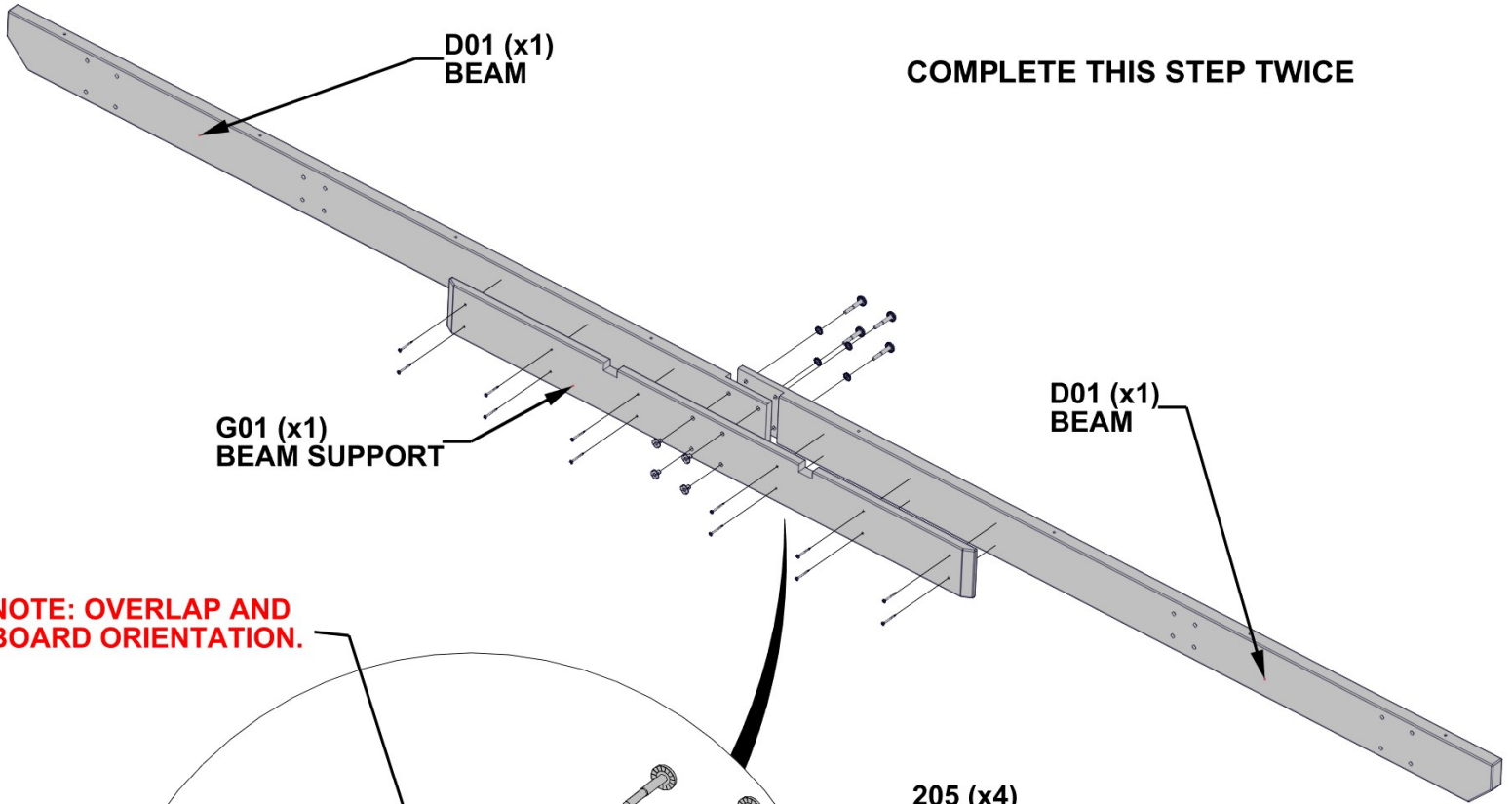

**NOTE: OVERLAP AND BOARD ORIENTATION.**

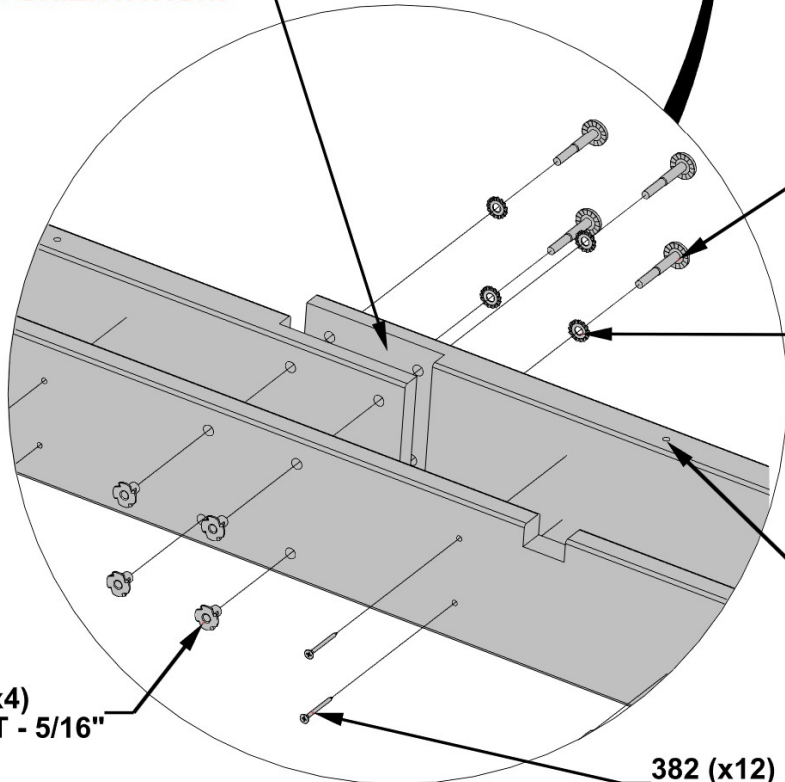

**379 (x4)**  
T-NUT - 5/16"

**205 (x4)**  
BOLT - 2 1/4"

**198 (x4)**  
WASHER - 8x19

**NOTE:**  
HOLE ORIENTATION  
ON TOP SIDE OF D01.

**382 (x12)**  
SCREW - 1 3/4"

# STEP 5 - PERGOLA ASSEMBLY

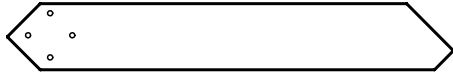

**D04| CORBEL-W4L16760**  
 (x2)| 1 7/16"x5 1/4"x35 1/16" (36x134x890)

| Qty | PART NUMBER | DESCRIPTION            |
|-----|-------------|------------------------|
| 8   | H100195     | BOLT WH 5/16x2 3/4 BLK |
| 8   | H100379     | T-NUT 5/16 BLK         |
| 8   | H100198     | WASHER LOCK EXT 8x19   |

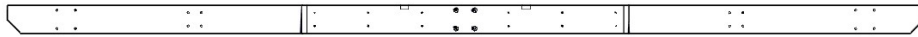

**BEAM ASSEMBLY  
FROM STEP 4**

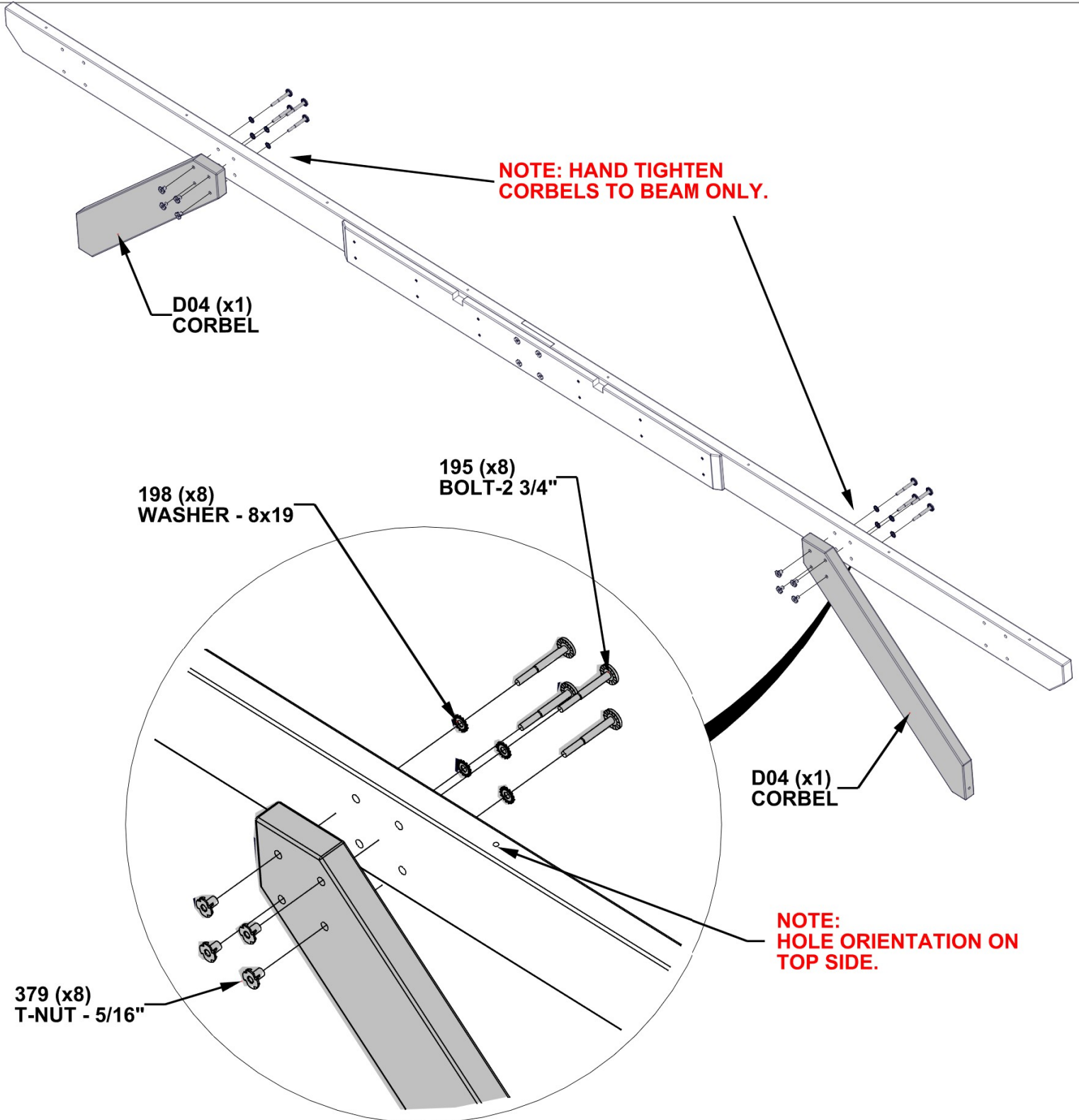

# STEP 6 - PERGOLA ASSEMBLY

| Qty | PART NUMBER | DESCRIPTION            |
|-----|-------------|------------------------|
| 8   | H100379     | T-NUT 5/16 BLK         |
| 8   | H100198     | WASHER LOCK EXT 8x19   |
| 8   | H100195     | BOLT WH 5/16x2 3/4 BLK |

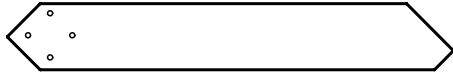

**D04| CORBEL-W4L16760**  
 (x1) | 1 7/16"x5 1/4"x35 1/16" (36x134x890)



**D08| CORBEL W/ ID TAG-W2A03481**  
 (x1) | 1 7/16"x5 1/4"x35 1/16" (36x134x890)

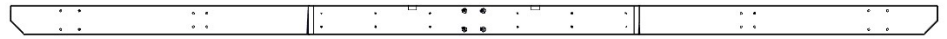

**BEAM ASSEMBLY FROM STEP 4**

**NOTE: HAND TIGHTEN CORBELS TO BEAM ONLY.**

**D08 (x1)  
CORBEL W/ ID TAG**

**NOTE: HOLE ORIENTATION ON TOP SIDE.**

**D04 (x1)  
CORBEL**

**195 (x8)  
BOLT-2 3/4"**

**198 (x8)  
WASHER - 8x19**

**379 (x8)  
T-NUT - 5/16"**

# STEP 7 - PERGOLA ASSEMBLY



**BEAM ASSEMBLY  
FROM STEP 5**

| Qty | PART NUMBER | DESCRIPTION            |
|-----|-------------|------------------------|
| 2   | H100564     | LAG SCREW WH 1/4x4 BLK |
| 2   | H100405     | WASHER LOCK EXT 6x15   |
| 8   | H100198     | WASHER LOCK EXT 8x19   |
| 8   | H101037     | BOLT WH 5/16x6 3/4 BLK |
| 8   | H100379     | T-NUT 5/16 BLK         |

**FOR THIS STEP, IT IS HELPFUL TO HAVE THREE ADDITIONAL PEOPLE TO HELP STAND UP ASSEMBLY AND ATTACH HARDWARE.**

**TIP: IF BOLT DOES NOT ENGAGE WITH T-NUT, CHECK FOR SAWDUST BUILD UP IN HOLES.**

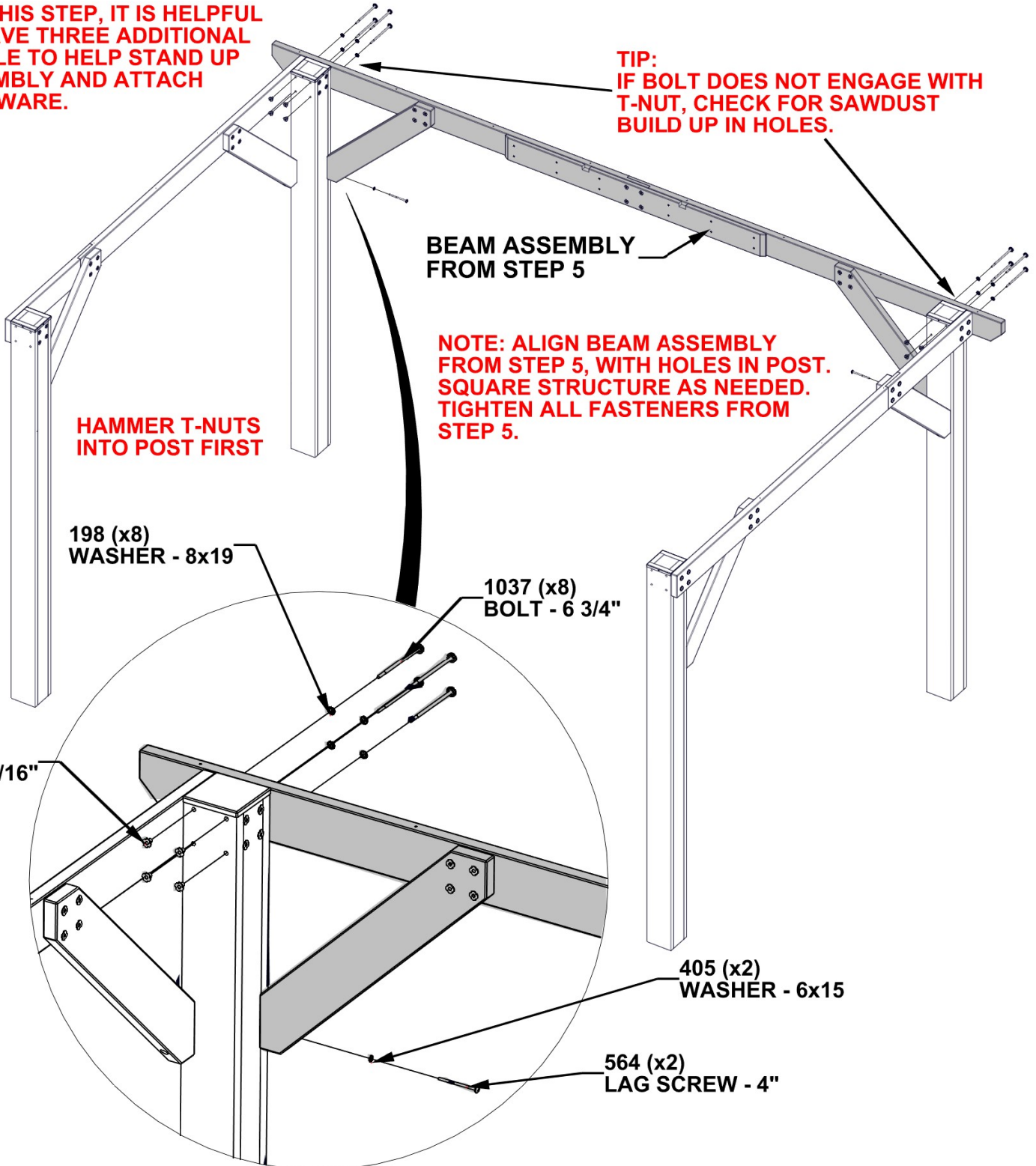



# STEP 8 - PERGOLA ASSEMBLY



| Qty | PART NUMBER | DESCRIPTION            |
|-----|-------------|------------------------|
| 2   | H100405     | WASHER LOCK EXT 6x15   |
| 2   | H100564     | LAG SCREW WH 1/4x4 BLK |
| 8   | H101037     | BOLT WH 5/16x6 3/4 BLK |
| 8   | H100198     | WASHER LOCK EXT 8x19   |
| 8   | H100379     | T-NUT 5/16 BLK         |

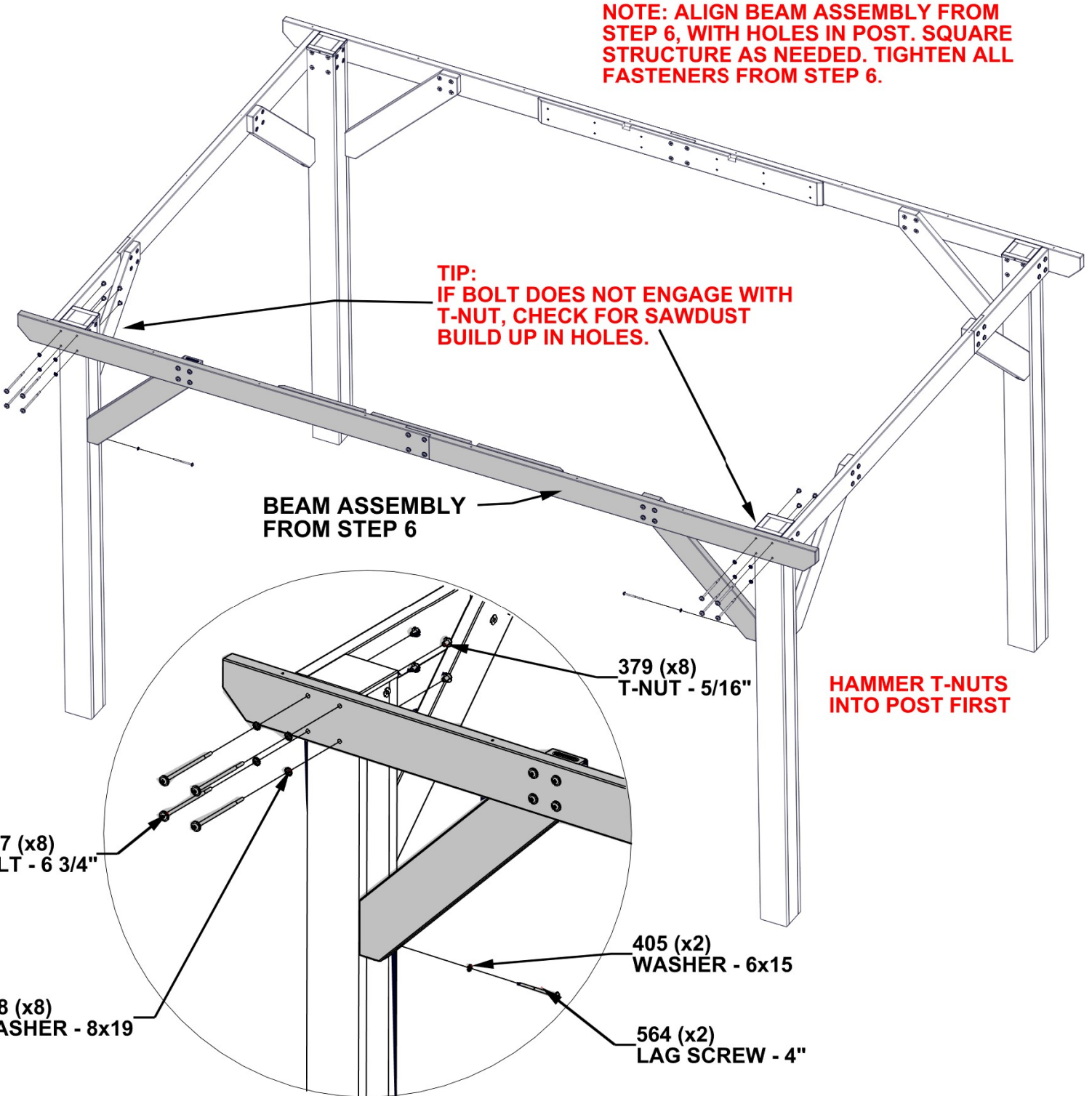

# STEP 9 - PERGOLA ASSEMBLY



**D05 | OUTER JOIST-W4L16761**  
 (x4) | 1 7/16"x5 1/4"x62 3/8" (36x134x1585)

| Qty | PART NUMBER | DESCRIPTION            |
|-----|-------------|------------------------|
| 8   | H100459     | BOLT WH 5/16x1 1/4 BLK |
| 8   | H100379     | T-NUT 5/16 BLK         |
| 8   | H100198     | WASHER LOCK EXT 8x19   |

**COMPLETE THIS STEP TWICE**

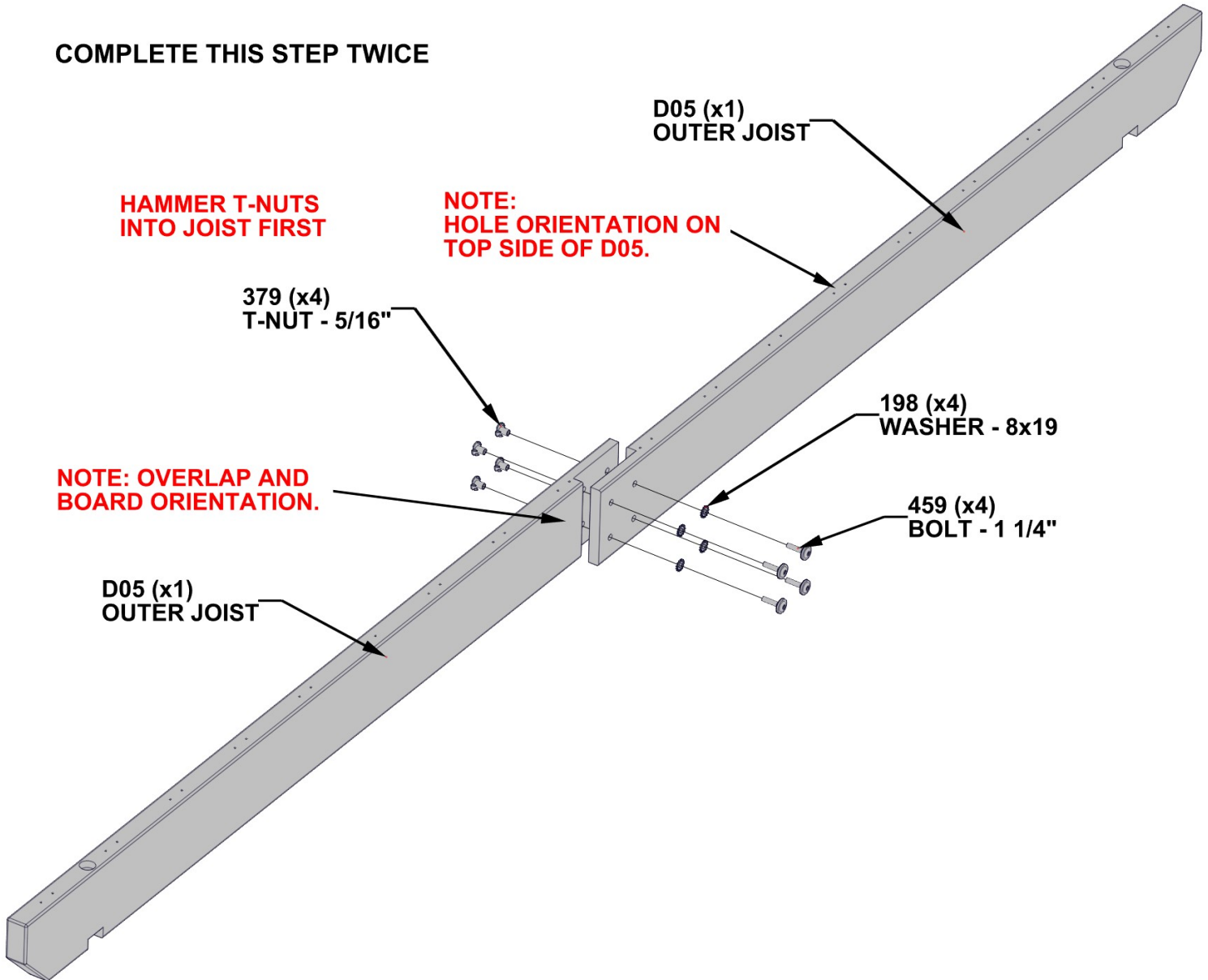

# STEP 10 - PERGOLA ASSEMBLY

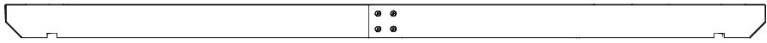

**OUTER JOIST ASSEMBLY  
FROM STEP 9**

| Qty | PART NUMBER | DESCRIPTION                 |
|-----|-------------|-----------------------------|
| 4   | H100204     | LAG SCREW WH 5/16x5 1/2 BLK |
| 4   | H100198     | WASHER LOCK EXT 8x19        |

**ALIGN SLOTS IN OUTER JOIST ASSEMBLY FROM PREVIOUS STEP WITH BEAM.  
INSERT LAG SCREWS THROUGH JOIST INTO PILOT HOLES.**

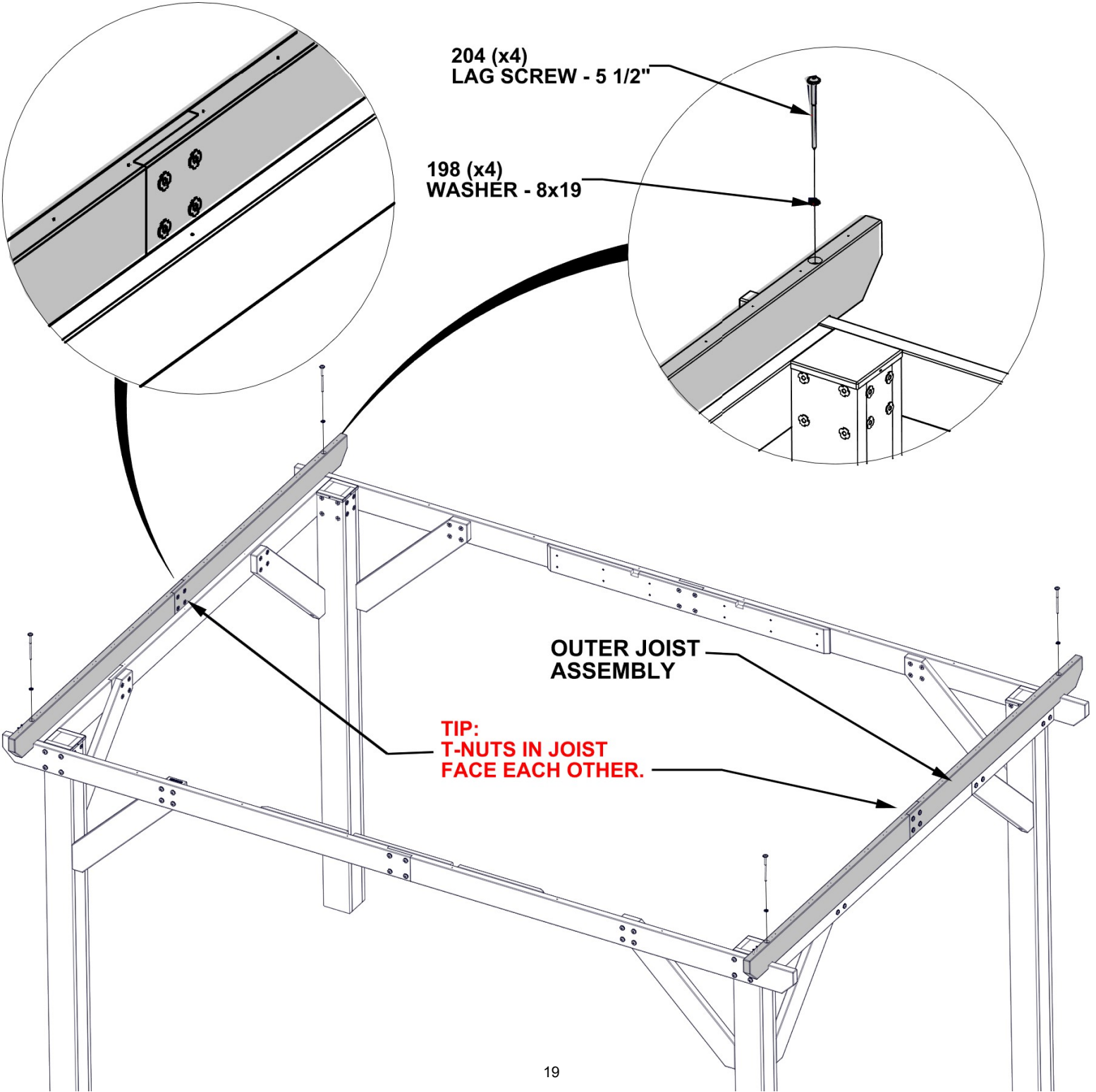

# STEP 11 - PERGOLA ASSEMBLY

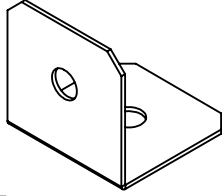

**A4M01785 | ANGLE BRACKET**  
(x6)

| Qty | PART NUMBER | DESCRIPTION       |
|-----|-------------|-------------------|
| 6   | H100797     | SCREW PWH 8x1 BLK |

**COMPLETE THIS STEP  
FOR BOTH SIDES**

**ALIGN ANGLE BRACKETS (6 TOTAL) WITH  
PILOT HOLES IN TOP SIDE OF BEAM.  
INSERT SCREWS AS SHOWN BELOW. DO  
NOT OVERTIGHTEN.**

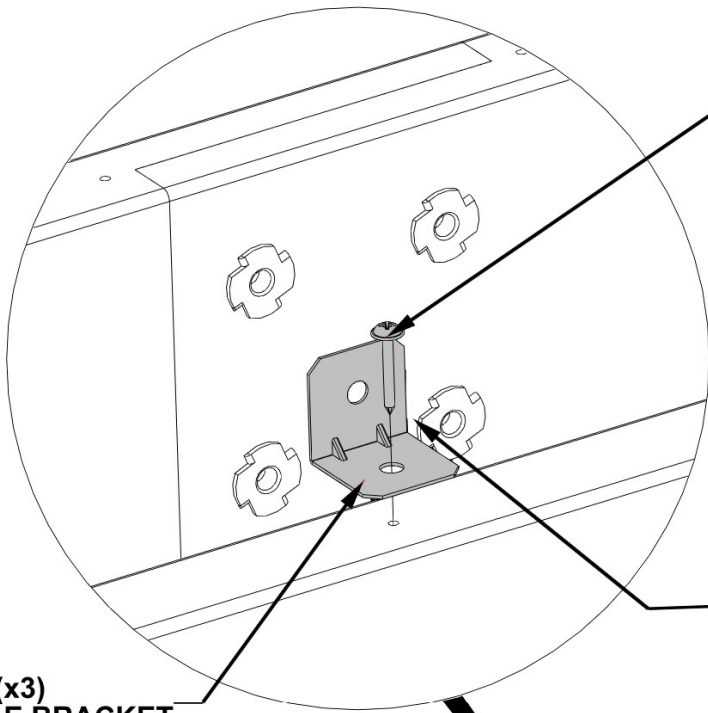

**797 (x3)  
SCREW - 1"**

**NOTE: PILOT HOLE**

**1785 (x3)  
ANGLE BRACKET**

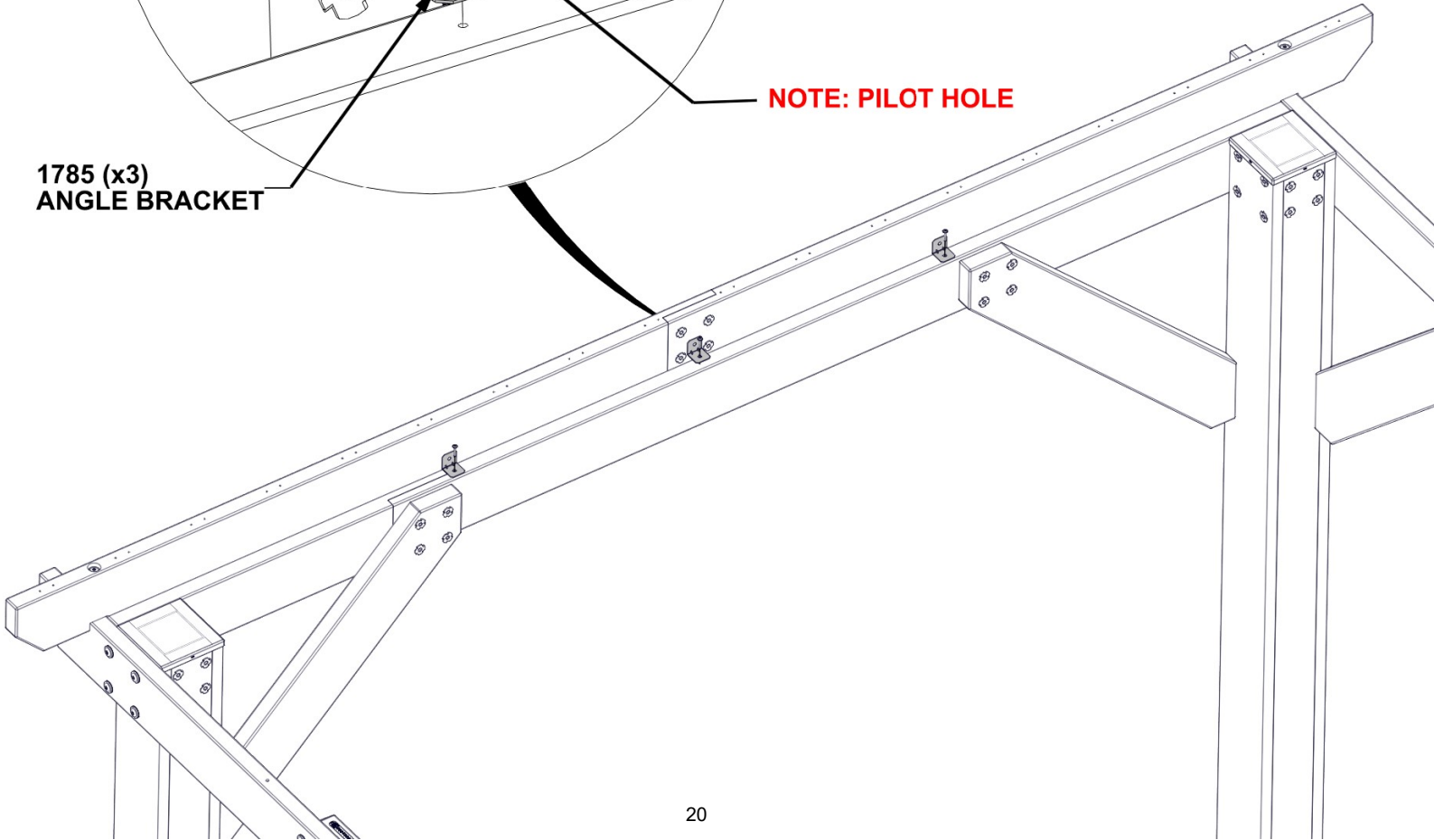



# STEP 12 - PERGOLA ASSEMBLY

| Qty | PART NUMBER | DESCRIPTION       |
|-----|-------------|-------------------|
| 6   | H100797     | SCREW PWH 8x1 BLK |

COMPLETE THIS STEP  
FOR BOTH SIDES

INSERT SCREWS AS SHOWN BELOW  
TO FASTEN ANGLE BRACKET TO SIDE  
OF OUTER JOIST. DO NOT  
OVERTIGHTEN.

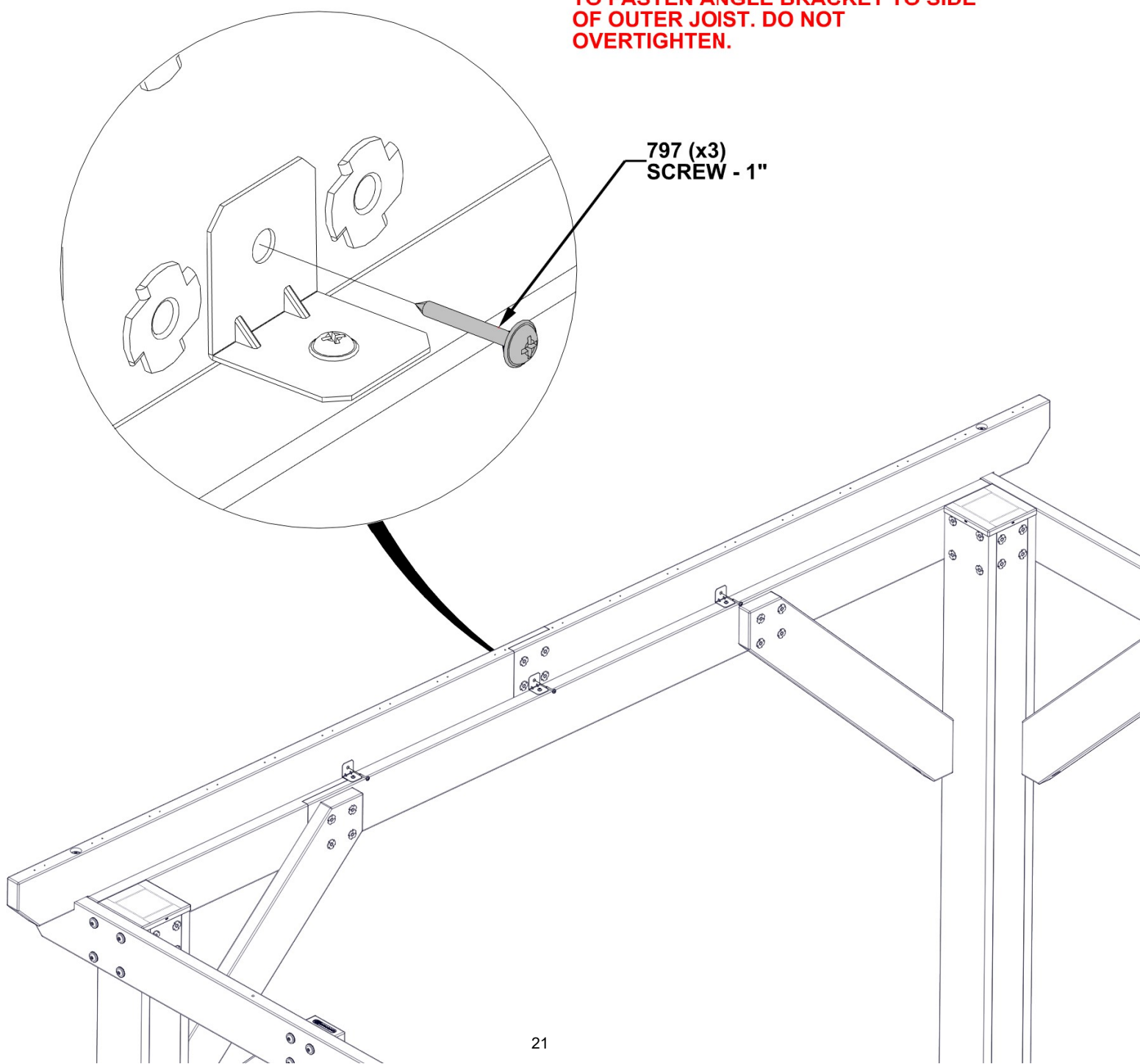

# STEP 13 - PERGOLA ASSEMBLY

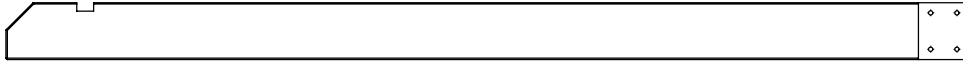

**D06 | INNER JOIST LONG-W4L16762**  
 (x6) | 1 7/16"x5 1/4"x89 1/2" (36x134x2274)

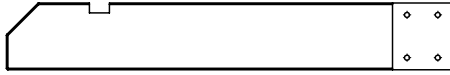

**D07 | INNER JOIST SHORT-W4L16763**  
 (x6) | 1 7/16"x5 1/4"x35 1/4" (36x134x896)

| Qty | PART NUMBER | DESCRIPTION            |
|-----|-------------|------------------------|
| 24  | H100379     | T-NUT 5/16 BLK         |
| 24  | H100198     | WASHER LOCK EXT 8x19   |
| 24  | H100459     | BOLT WH 5/16x1 1/4 BLK |

**COMPLETE THIS STEP SIX TIMES**

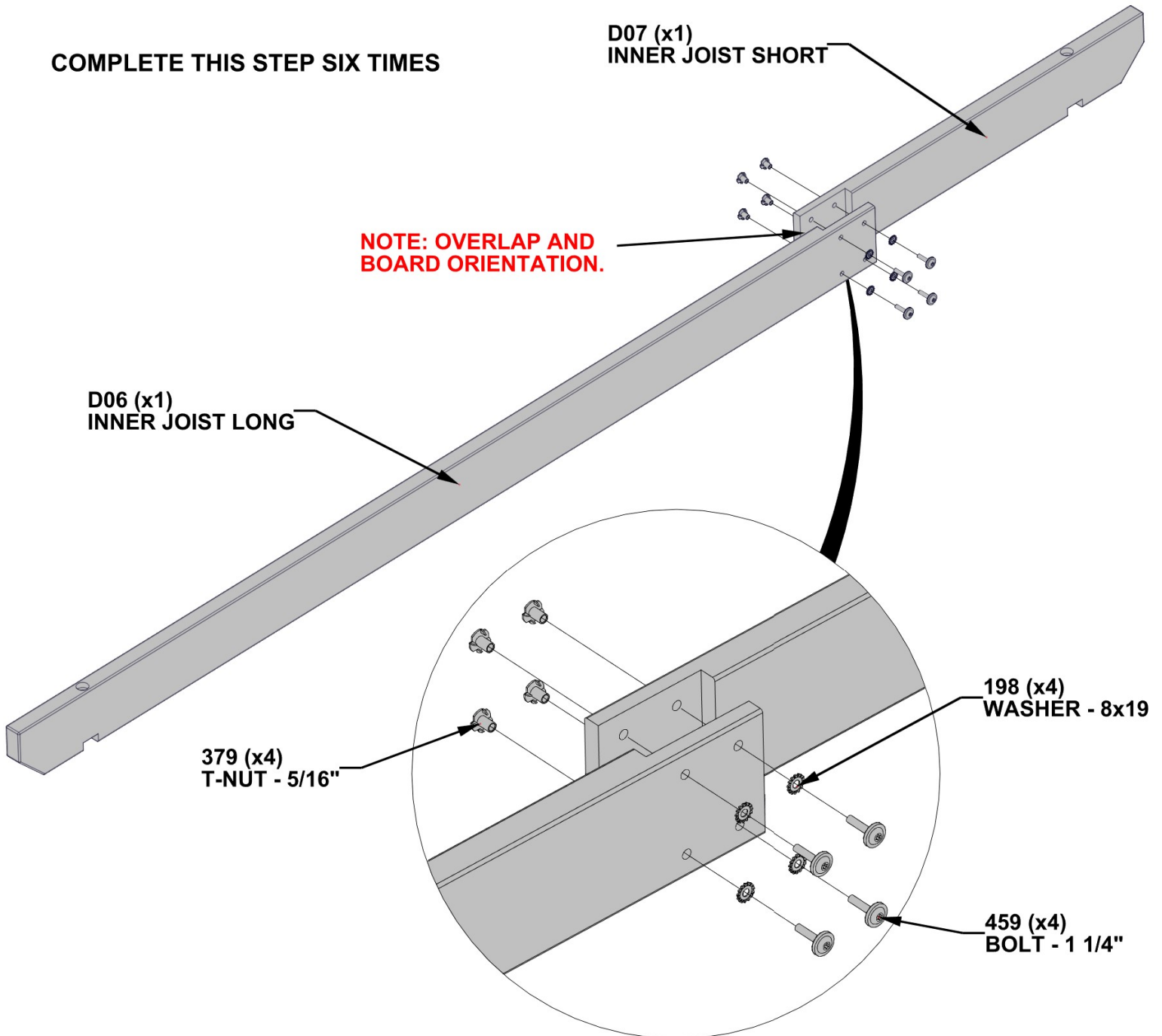

# STEP 14 - PERGOLA ASSEMBLY



**INNER JOIST ASSEMBLY  
FROM STEP 13**

| Qty | PART NUMBER | DESCRIPTION                 |
|-----|-------------|-----------------------------|
| 12  | H100204     | LAG SCREW WH 5/16x5 1/2 BLK |
| 12  | H100198     | WASHER LOCK EXT 8x19        |

**ATTACH INNER JOIST ASSEMBLIES FROM PREVIOUS STEP USING PILOT HOLES IN BEAMS.**

**ENSURE ALL LAP JOINTS ALTERNATE**

**INNER JOIST ASSEMBLY**

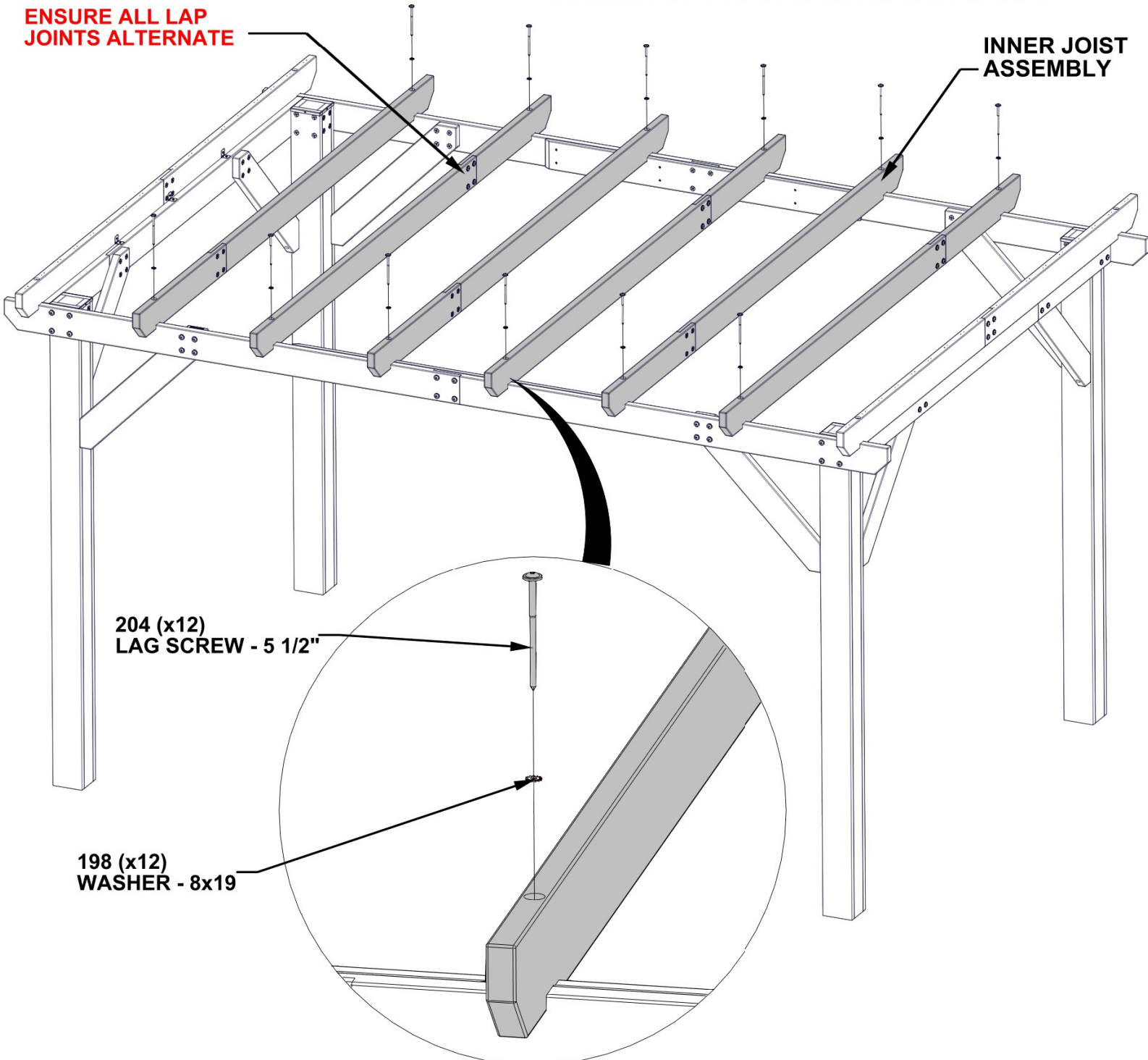

**204 (x12)  
LAG SCREW - 5 1/2"**

**198 (x12)  
WASHER - 8x19**

# STEP 15 - PERGOLA ASSEMBLY



**J01 | END SLAT-W4L16764**  
 (x36) | 15/16"x2 3/8"x50 3/16" (24x60x1274)

| Qty | PART NUMBER | DESCRIPTION          |
|-----|-------------|----------------------|
| 36  | H100405     | WASHER LOCK EXT 6x15 |
| 36  | H101139     | BOLT WH 1/4x7/8 BLK  |
| 36  | H100398     | TNUT-1/4" BLK        |



**J02 | MIDDLE SLAT-W4L16765**  
 (x18) | 15/16"x2 3/8"x68 3/8" (24x60x1736)

**COMPLETE THIS STEP 18 TIMES**

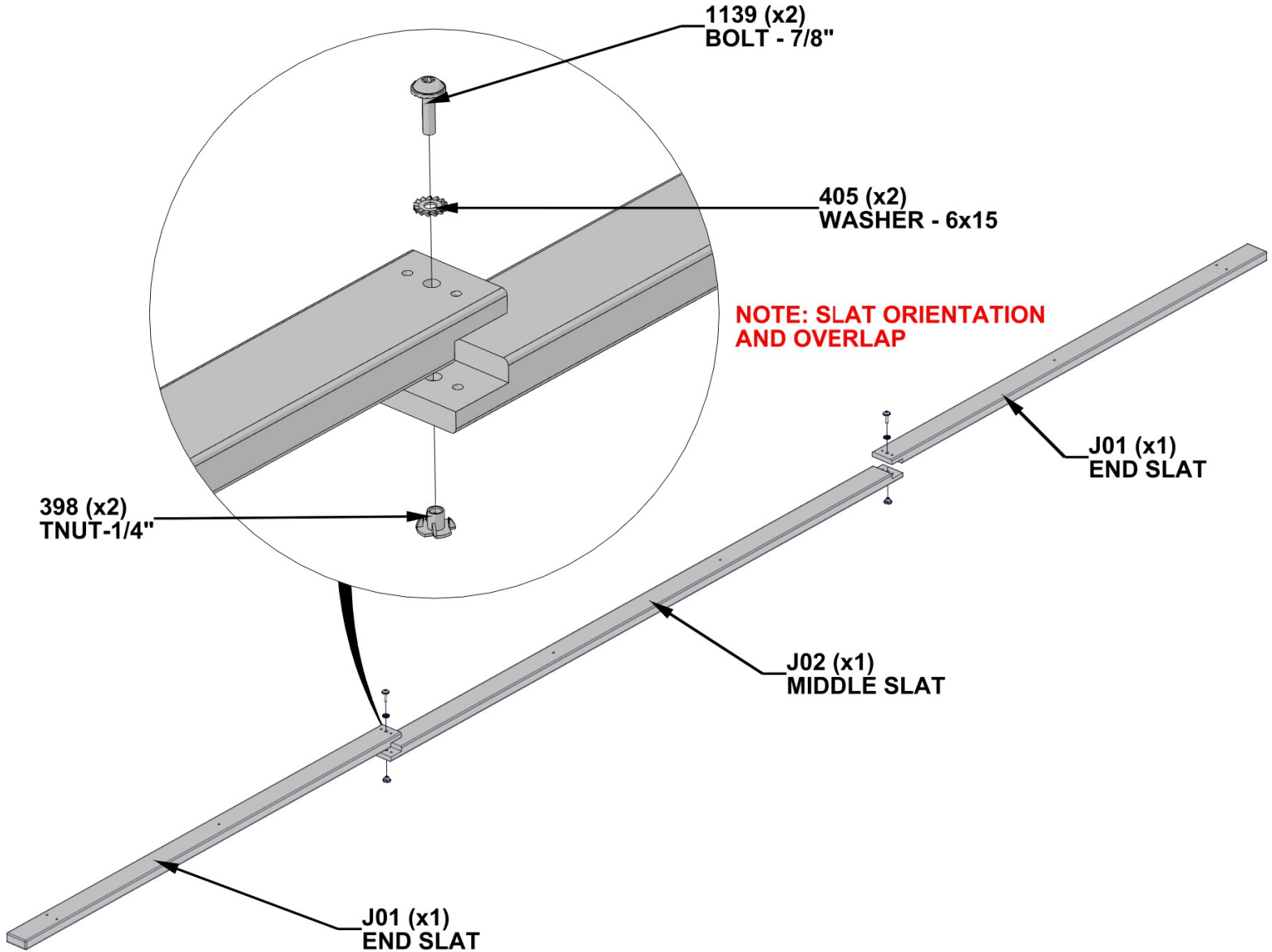



# STEP 16 - PERGOLA ASSEMBLY

## SLAT ASSEMBLY FROM STEP 15

| Qty | PART NUMBER | DESCRIPTION       |
|-----|-------------|-------------------|
| 16  | H100391     | SCREW PFH 8x2 BLK |

**START WITH FOUR SLAT ASSEMBLIES AND PLACE THEM ON TOP OF JOIST IN THE ORIENTATION BELOW. START FROM THE FRONT AND WORK TOWARD THE BACK, ALIGNING SLATS AT EACH END WITH PILOT HOLES. SCREW IN PLACE.**

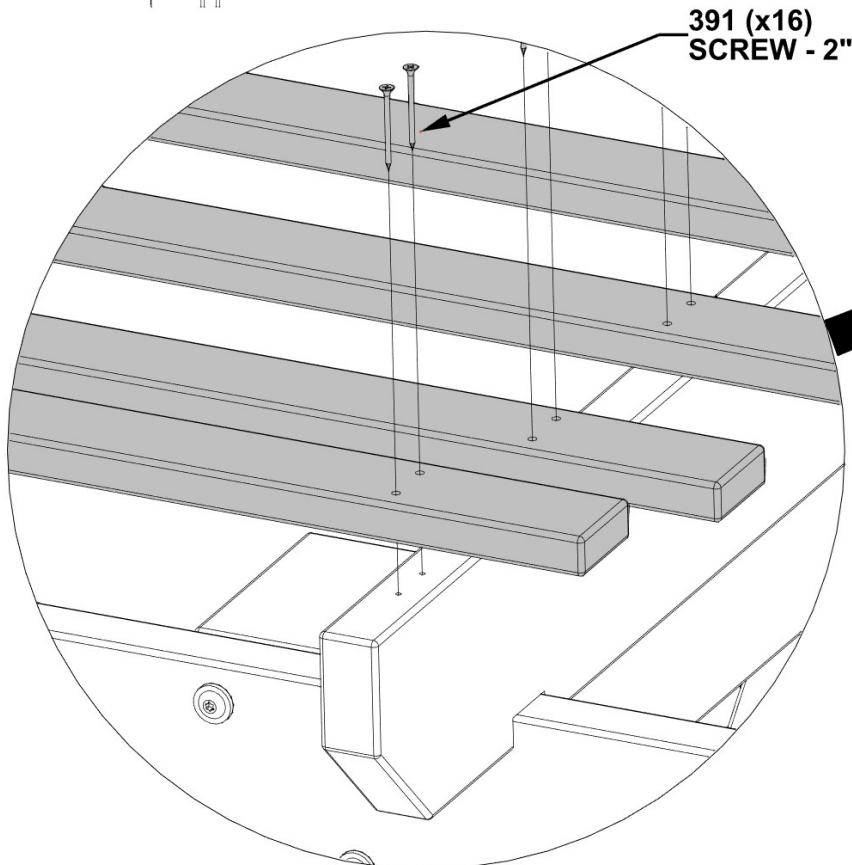
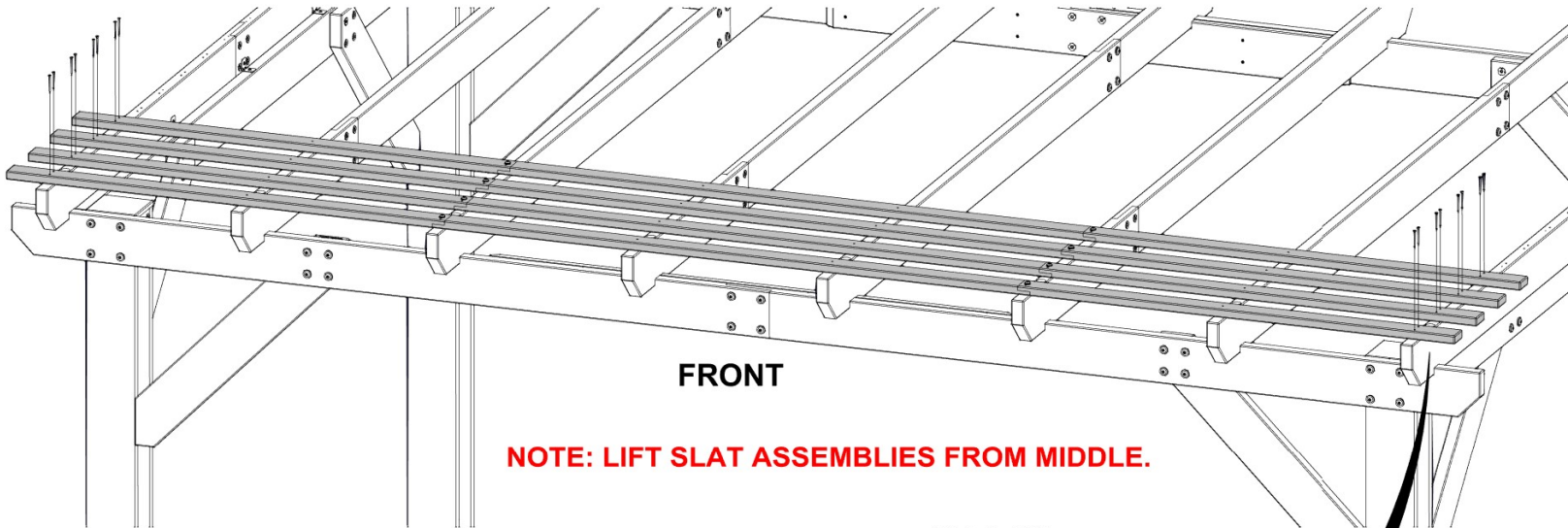

# STEP 17 - PERGOLA ASSEMBLY

| Qty | PART NUMBER | DESCRIPTION       |
|-----|-------------|-------------------|
| 32  | H100391     | SCREW PFH 8x2 BLK |

**NOTE: WITH ENDS OF SLAT ASSEMBLIES FASTENED IN PLACE, INSERT REMAINING SCREWS TO FASTEN CENTER OF SLATS TO JOIST.**

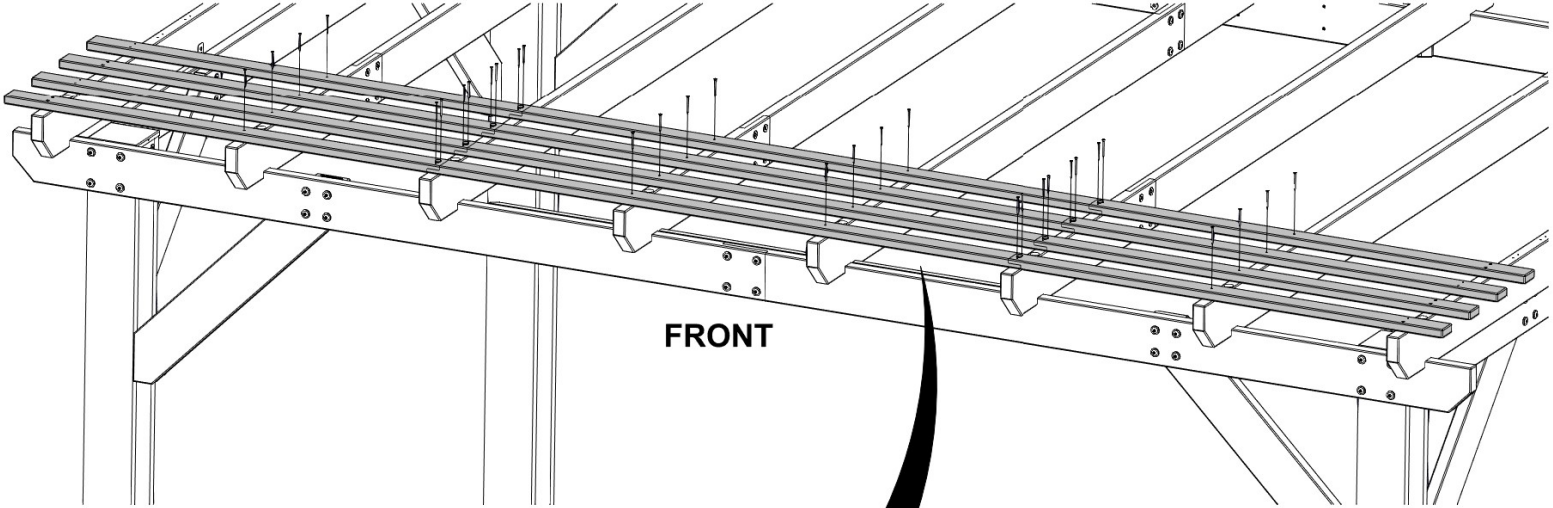

**FRONT**

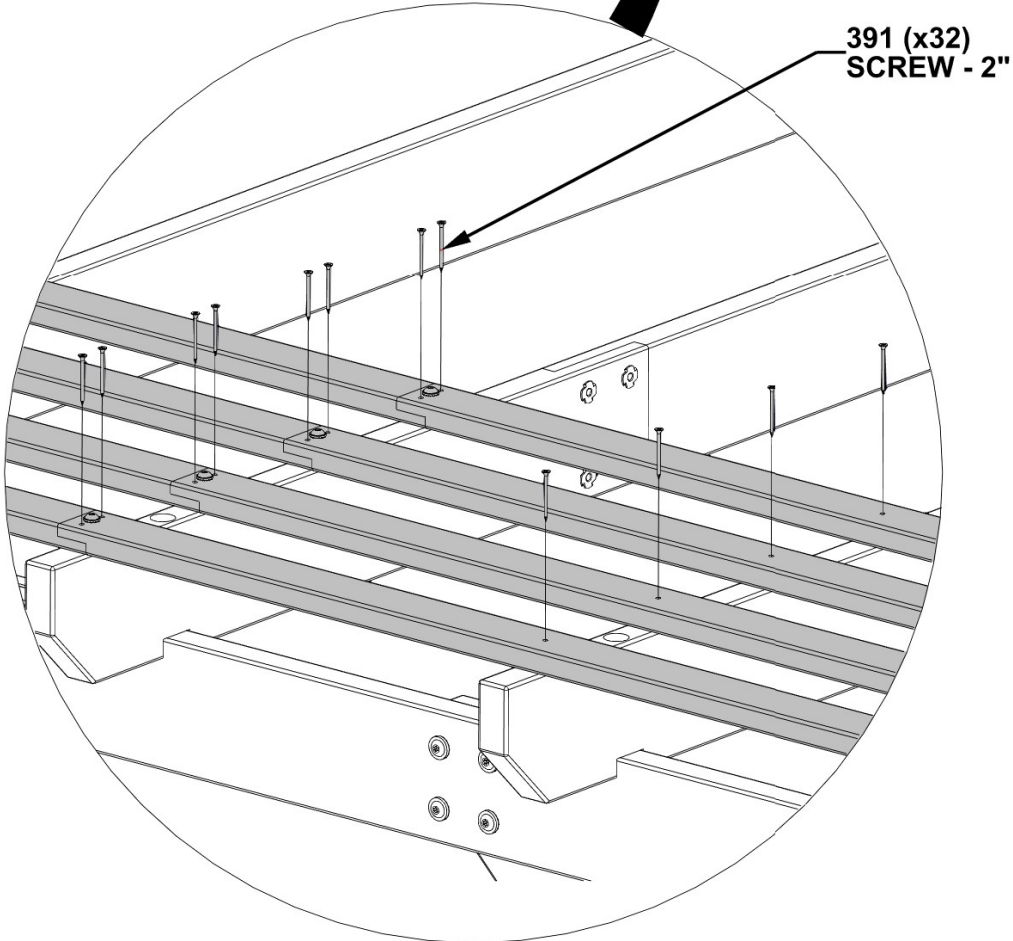

**REPEAT STEPS 16 THROUGH 17  
TO INSTALL REMAINING SLATS**

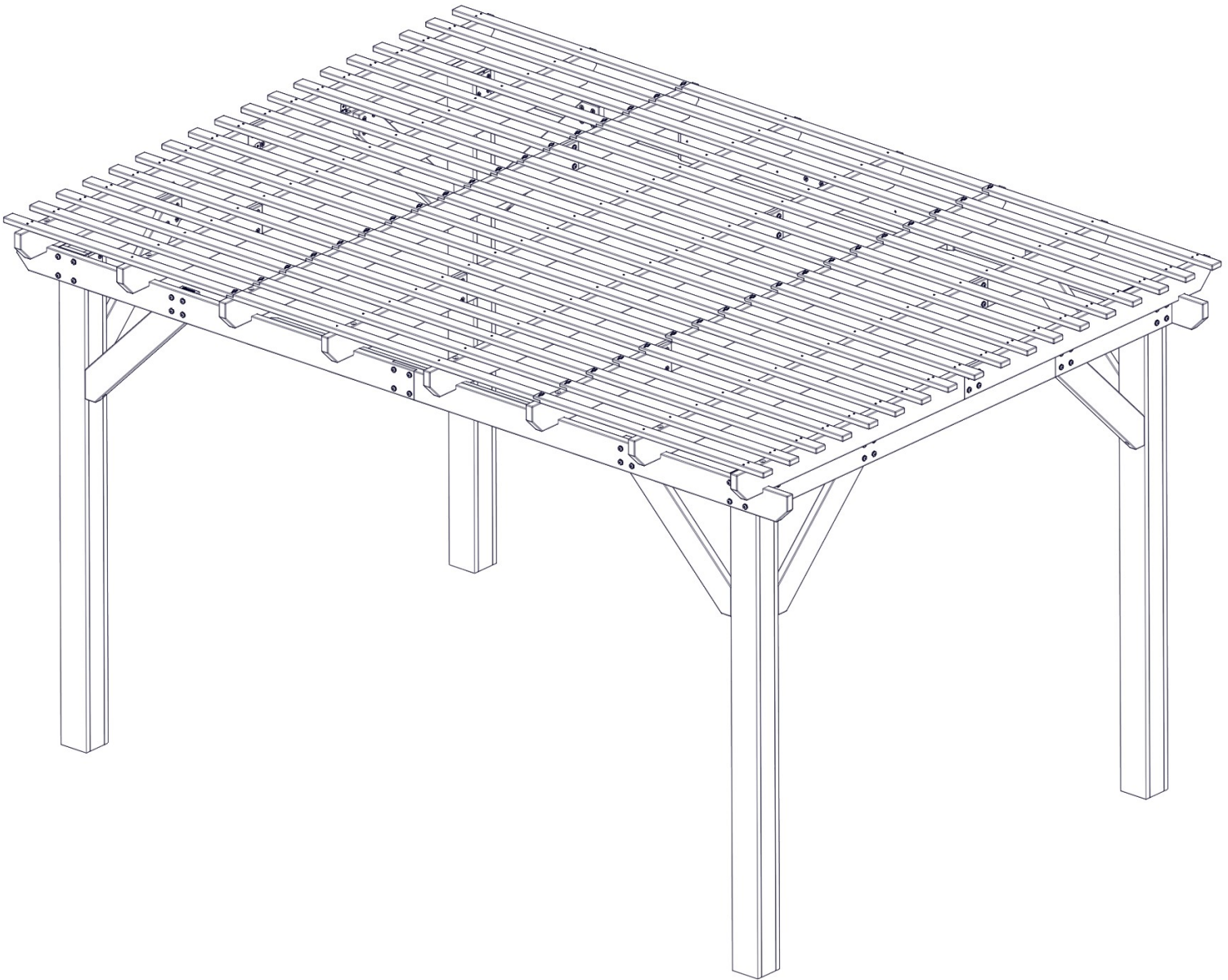

## STEP 18 - PERGOLA ASSEMBLY

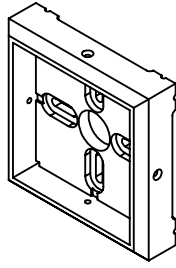

A100029  
(x4) | FOOT 142 SQUARE POST

**DECIDE WHERE TO PLACE THE PERGOLA. PLACE THE PERGOLA EXACTLY WHERE IT WILL BE ANCHORED WHEN COMPLETED AND SLIDE A FOOT UNDER EACH POST.**

**NOTE:  
MANUFACTURER RECOMMENDS INSTALLATION ON CONCRETE SURFACE OR CONCRETE PIERS. SEE BELOW.**

**FOR INSTALLATION ON WOOD DECKS, YOU MUST ENSURE THERE IS AMPLE STRUCTURAL SUPPORT UNDER DECK.**

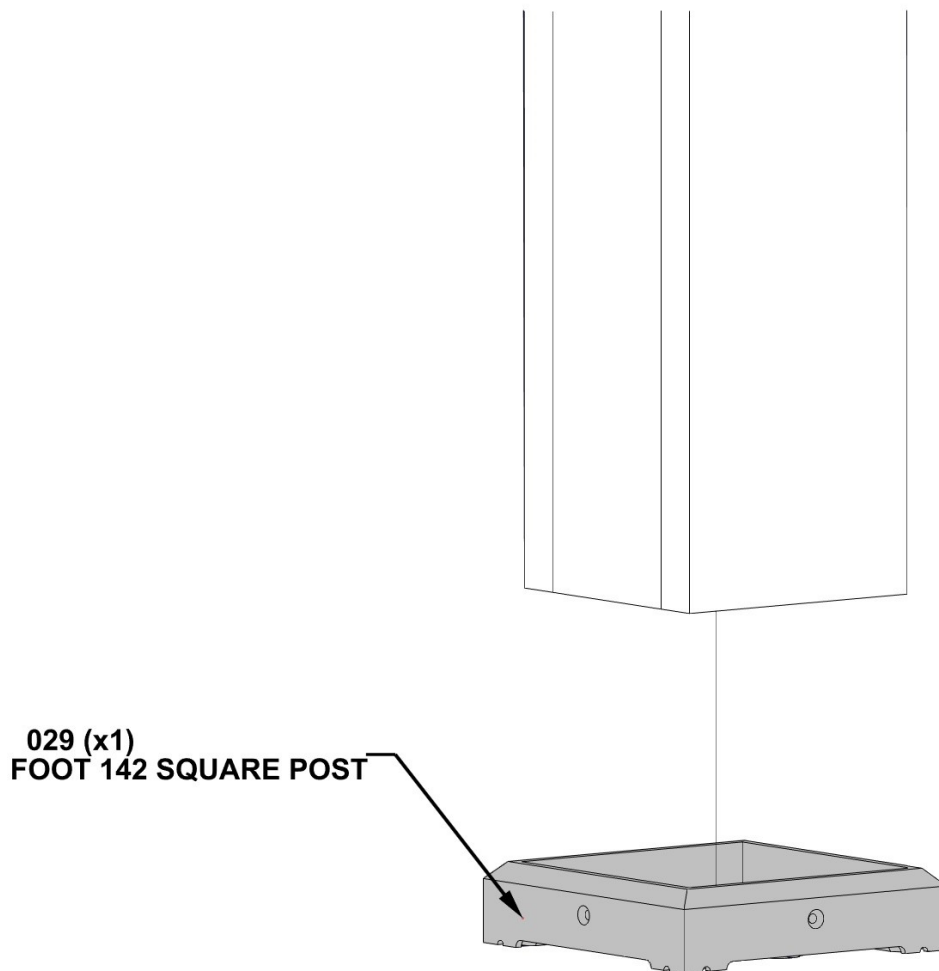

**REPEAT ON ALL POSTS**

**SQUARE POST AND TIGHTEN ANY HARDWARE BEFORE CONTINUING TO NEXT STEP.**



# STEP 19 - PERGOLA ASSEMBLY

**USE CHALK TO TRACE AROUND THE EDGES OF EACH FOOT TO MARK THE FEET LOCATIONS.**

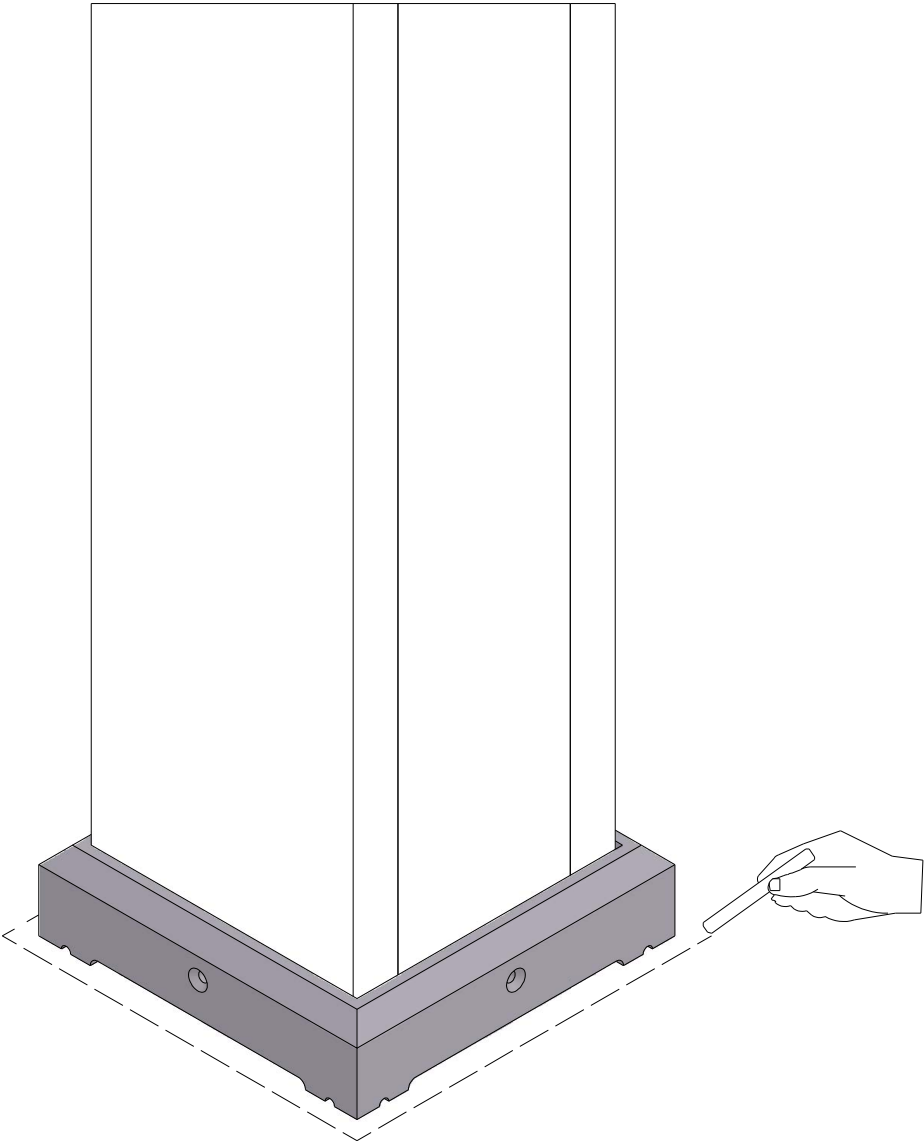

# STEP 20 - PERGOLA ASSEMBLY

| Qty | PART NUMBER | DESCRIPTION           |
|-----|-------------|-----------------------|
| 16  | H100630     | WASHER FLAT 8x19 BLK  |
| 16  | H100120     | CONCRETE ANCHOR 1/4x2 |

**MOVE THE PERGOLA ASIDE AND PLACE EACH FOOT INSIDE THE LINES DRAWN IN THE PREVIOUS STEP. USE A 3/16" CONCRETE DRILL BIT TO DRILL PILOT HOLES INTO CONCRETE PAD.**

**FASTEN POST FOOT AS SHOWN BELOW.**

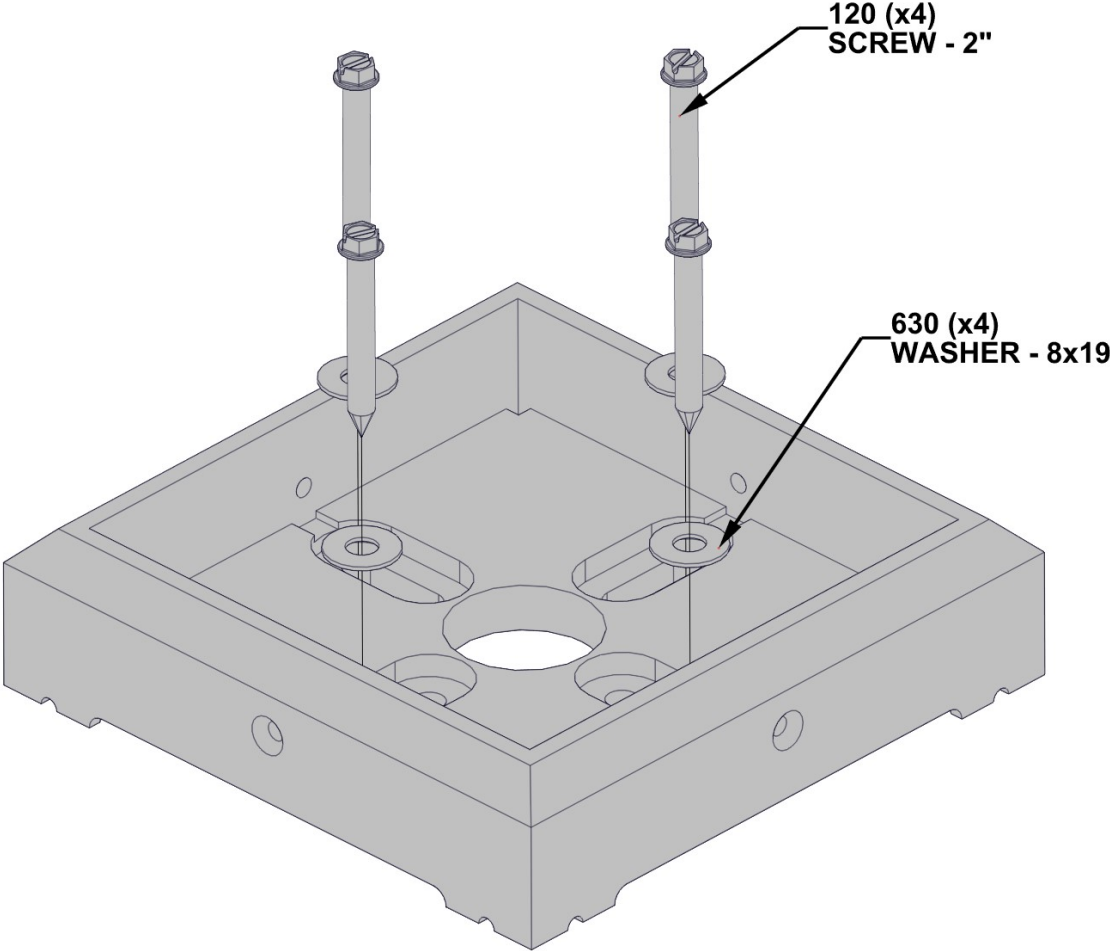

# STEP 21 - PERGOLA ASSEMBLY

| Qty | PART NUMBER | DESCRIPTION           |
|-----|-------------|-----------------------|
| 16  | H100200     | SCREW PFH 8x1 1/2 BLK |

**MOVE THE PERGOLA BACK INTO PLACE,  
SETTING EACH POST INSIDE A FOOT AND MOUNT  
AS SHOWN USING THE PROVIDED HARDWARE.**

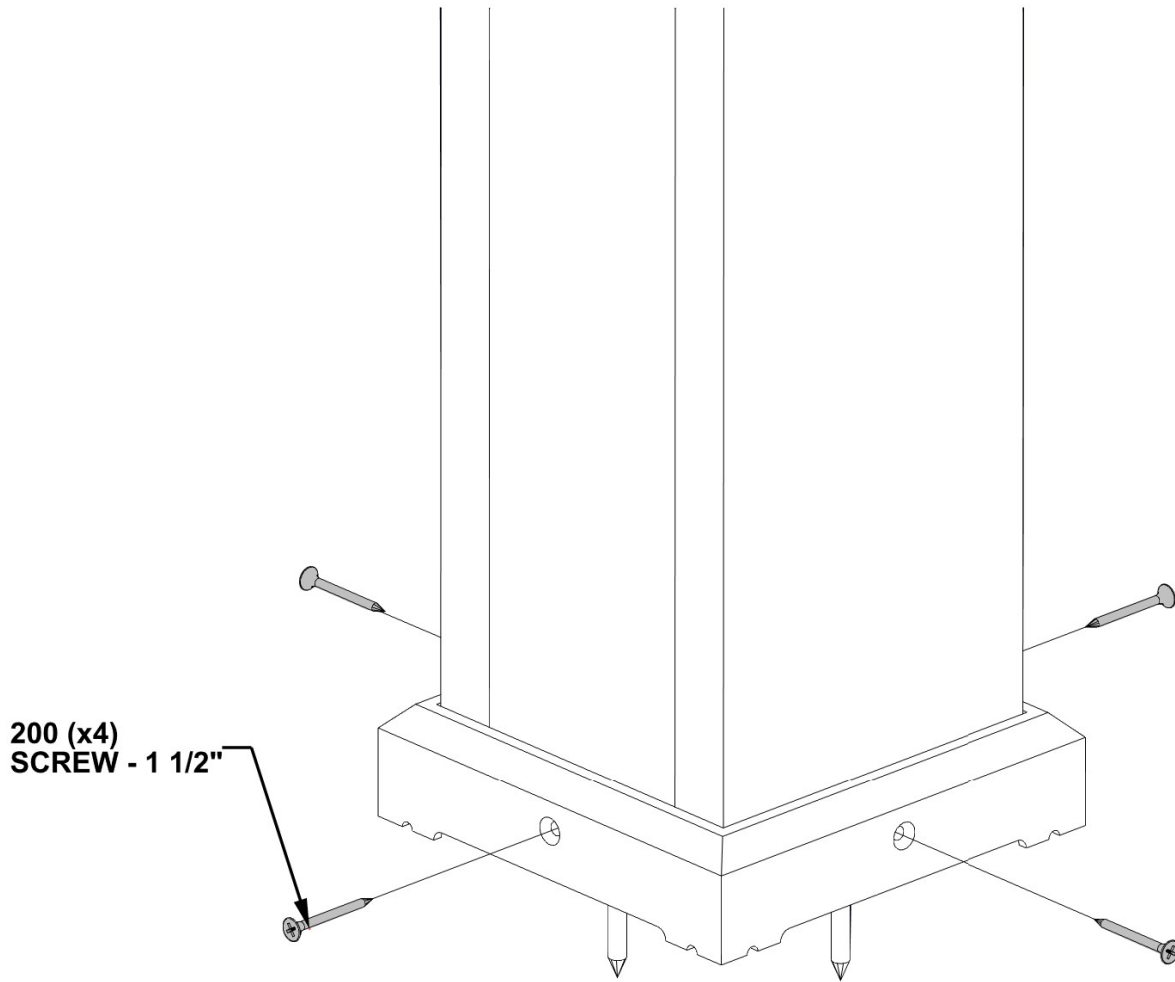

**REPEAT ON ALL POSTS**

# STEP 22 - PERGOLA ASSEMBLY



| Qty | PART NUMBER | DESCRIPTION         |
|-----|-------------|---------------------|
| 2   | H100392     | SCREW PWH 8x3/4 BLK |

**A100241**  
(x1) | BYD ID TAG (SMALL) WITHOUT AGES

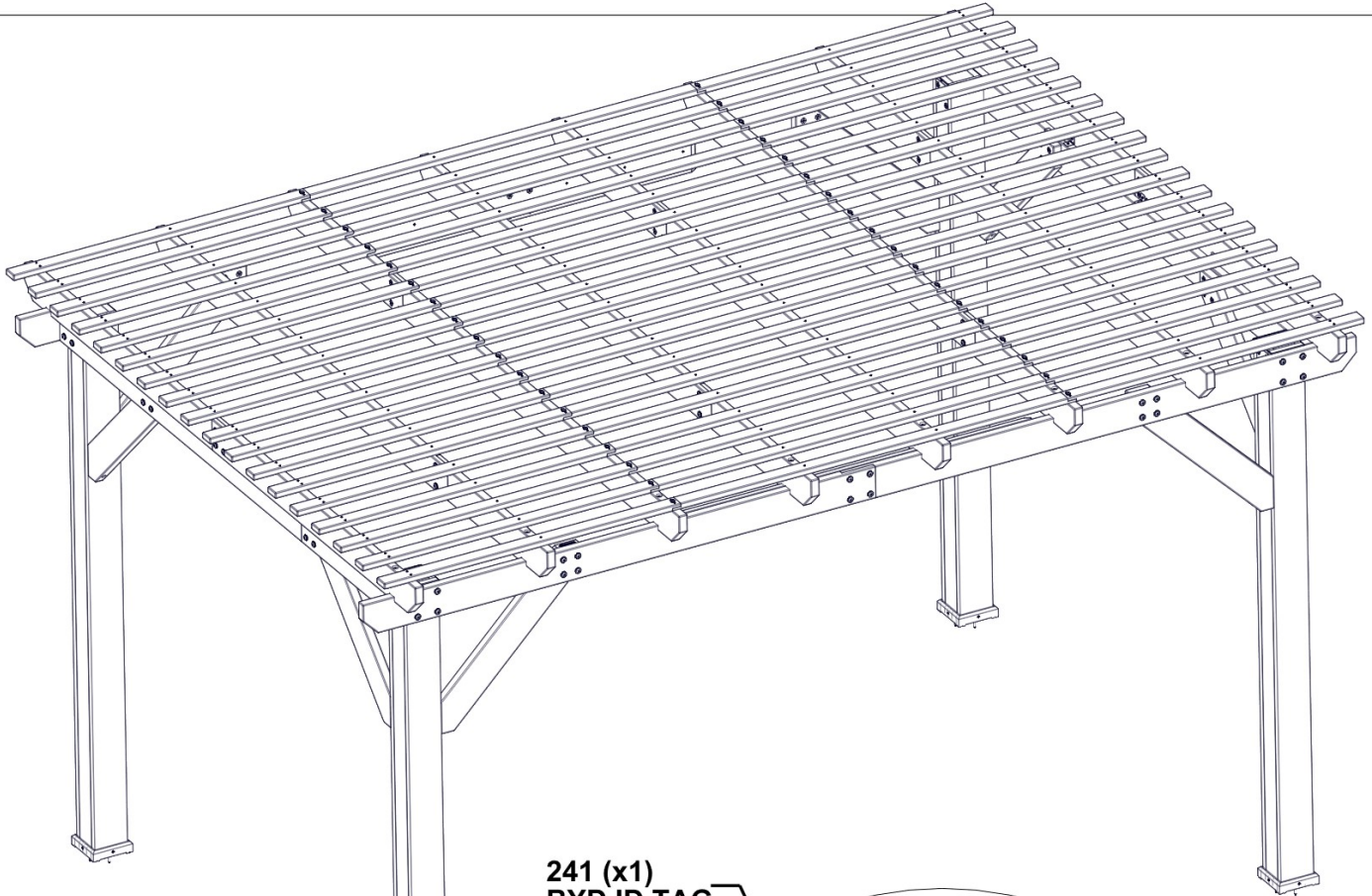

**241 (x1)**  
**BYD ID TAG**

**392 (x2)**  
**SCREW - 3/4"**

## STEP 23: ELECTRICAL ENCLOSURE

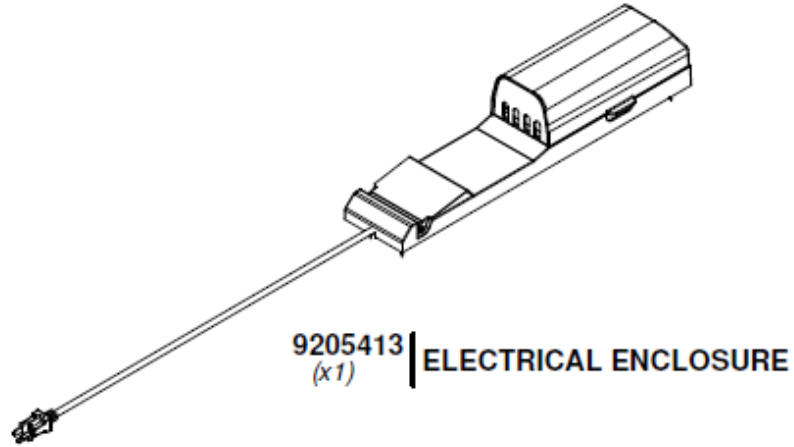

FOR ELECTRICAL ENCLOSURE INSTALLATION REFER TO ASSEMBLY INSTRUCTIONS THAT COMES PACKAGED WITH THE ELECTRICAL ENCLOSURE KIT. INSTALL ON ANY POST THAT IS DESIRED. FOLLOW DIRECTIONS FOR PROPER INSTALLATION.